



Part of the COBA Group



April 2022

CI/Sfb		(43Y+44)	Hh
--------	--	----------	----

Specialist Stair Nosings and Floor Trims

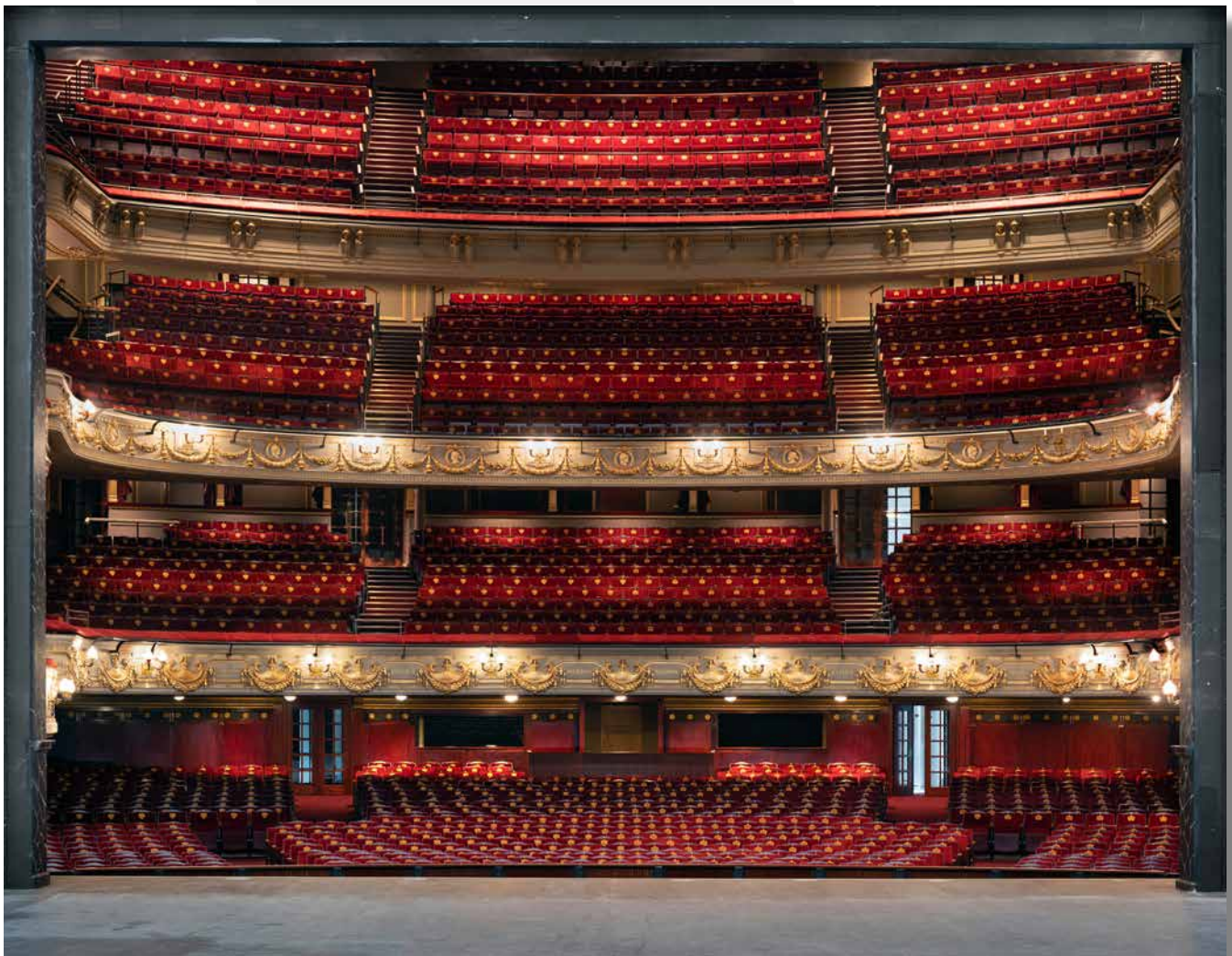

The Comprehensive CAT Catalogue April 2022

Est. 1986

www.thecatweb.com





C.A.T. Brands

Designer Home Collection™

Stick Fix™

Feline™

Fab™

Timberline™

Tag Trim™

Mainline™

Kliks™

Kliks Slim™

Kliks Spectrum Zip™

Reflex™

Vertex™

Olympic

The Akeman Collection™



Lead Times Guide

TSO To Special Order Profiles	Up to 14 working days from receipt of order - subject to availability
--------------------------------------	--

Fabrication - 1 to 3 curves Flooring profiles - curves Stair nosings - curves Stair rods - curving (in addition to stair rod lead times)	Up to 14 working days Up to 14 working days 7 working days
--	--

Notes:

For special finishes, please add 14 working days to the quoted lead times.

For large fabrication orders, please contact C.A.T. sales for lead times.

Powder Coating	Contact C.A.T. sales
-----------------------	----------------------

Matwell Frames - 1 - 3 matwells	7 working days
--	----------------

Stair Nosings & Edgings up to 100 metres: Brass Stair Nosings With PVC & Brass Infills Polished & Satin Finishes Antique Brass & Antique Bronze Finishes Aluminium Stair Nosings With PVC & Aluminium Infills Mill Finish Polished & Satin Finishes Aluminium Stair Nosings With Olympic Grip Infill Mill Finish Aluminium Stair Nosings With Carborundum Infill Mill Finish Stainless Steel Stair Nosings With PVC Infills Bright & Brushed Finishes	7 working days 14 working days 3 working days 7 working days 3 working days 3 working days 14 working days 10 working days
--	---

Note: For larger orders, please contact C.A.T. sales for lead times.

Stringer Angles up to 100 Units: Aluminium - stock subject to availability Brass - Polished & Satin Finishes Antique Brass & Antique Bronze Finishes	3 working days 14 working days 21 working days
--	--

Note: For larger orders, please contact C.A.T. sales for lead times.

Stair Rods & Eyes - up to 50 Rods and 100 Eyes Polished Brass Antique Brass & Antique Bronze Finishes Chrome & Nickel Finishes	7 working days 14 working days 14 working days
--	--

Note: For larger orders, please contact C.A.T. sales for lead times.



Stick Fix™ Profiles

Look for the Stick-Fix™ logo



Key Benefits



No drilling or mechanical fixing required



No risk to underfloor heating pipes



No risk to underfloor cables



Rapid install time

General

A solvent free, rubber resin bonding medium based on hot melt adhesive which is factory affixed to a selection of C.A.T. flooring and wall protection profiles to facilitate adhesive-only site fixing.

Key Properties

- Solvent free
- Very aggressive, pressure sensitive adhesion
- Non-hardening, permanently flexible bond
- Forms strong, waterproof bond
- Instant fix - no curing time required
- Service temperature 0°C to 40°C

Technical Properties

Description	Units	Nominal Value
Specific Gravity	g/cm ²	0.98
180° Peel Adhesion (23°C)	N/cm	25
Softening Point (Ring and Ball)	°C	85
Cohesion	Kgs/cm ²	6
Initial Tack (Rolling Ball)	mm	30

Floor Preparation

The floor/step surface to receive the adhesive only fixing must be completely free of dust, grease, paint or other contaminants likely to prevent or compromise the effective bonding of the profile to the substrate material.

Additional Information

Stick-Fix should not be used where good chemical or UV resistance is required.

The specifier/installer should determine the suitability of adhesive-only fixing having taken into account the nature of the application and the type and condition of the substrate. In determining that adhesive-only is appropriate, the specifier/installer shall assume all risk and liability connected therewith, including correct site preparation.

Guide to Stair Nosings

C.A.T. manufacture a large range of stair nosings in Brass, Aluminium and Stainless Steel. Stair nosings across the industry are regulated by Part M and Part K of the building standards. Although this is not law C.A.T. suggest the best practice is imperative for safety on all steps and staircases. Please see the following guide.

6 Steps to a Safer Staircase

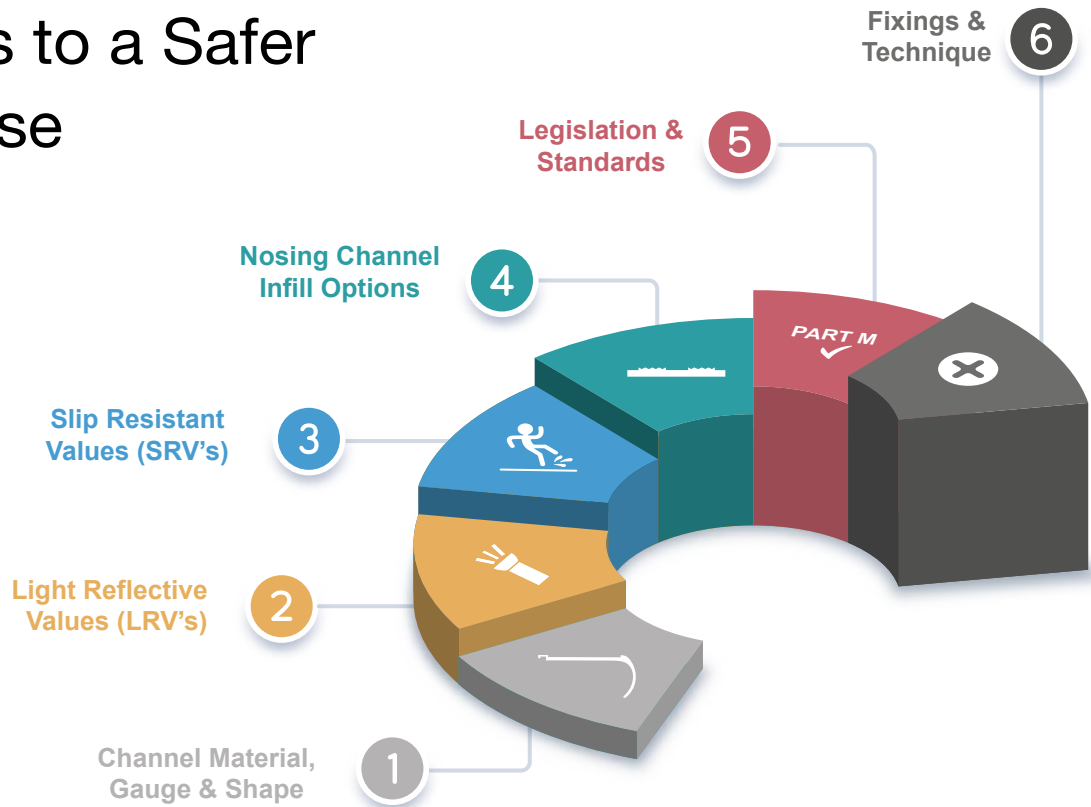

1. Channel Material, Gauge & Shape

Choosing the Front Shape

There are three main step profile shapes. The names describe the shape of the front edge, which is matched to the profile of the steps:

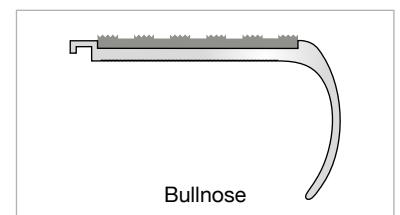
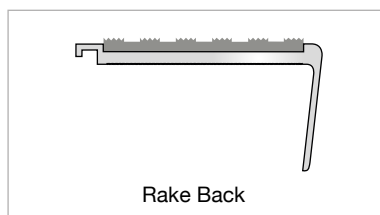
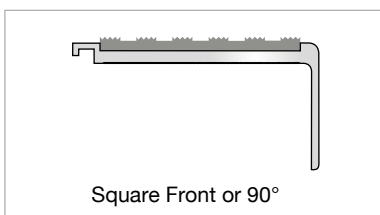

Choosing the Back Edge (gauge)

Depending on the type of floor finish the back edge of the stair nosing may be 5mm gauge for carpet or carpet tiles, 2.5mm gauge for LVT and vinyl or a ramped back for resilient flooring or where no floor covering exists.

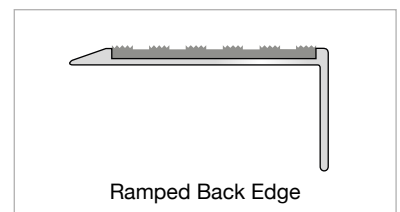
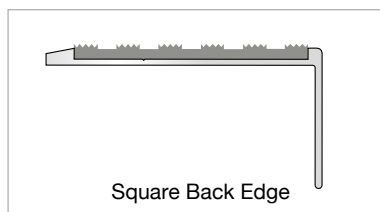
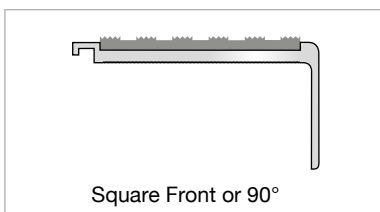



Choosing the Material



Brass

Brass Nosings are supplied in the following finishes:

- Polished Brass
- Satin Brass
- Antique Brass*
- Antique Bronze*



Aluminium

Aluminium Nosings are supplied in the following finishes:

- Mill Aluminium
- Satin Aluminium
- Polished Aluminium
- Black Anodised*

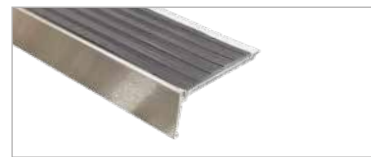

Stainless Steel

Stainless Steel Nosings are supplied in the following finishes:

- Brushed Stainless Steel
- Bright Stainless Steel

* Please note that although matched to control samples, finishes will vary from batch to batch. Antique finishes are hand applied to special order.

2. Light Reflective Values (LRV's)

C.A.T. offer a range of stair nosing's with a choice of aluminium, brass or coloured PVC inserts. Building regulations require that the stair nosing contrasts with the flooring material by a minimum of 30 points on the Light Reflectance scale or LRV.

LRV is a measurement that expresses the percentage of light that is reflected from a surface with lighter finishes at the upper end of the scale and darker finishes at the lower. Designers of buildings need to comply with the building regulations applicable to the structure under consideration. Since 2004 guidance has existed on access to and use of buildings. The guidance is particularly concerned with provisions to assist the disabled, including those who are visually impaired.

The Light Reflectance Scale is calibrated from 0 to 100 and measures how much light is reflected from the colour and shade of material where Black = LRV 4.25 and White = LRV 84.22.

The guidance highlights the need for certain surfaces and features to “contrast visually” with their surroundings. This is relevant to a wide range of non-residential buildings including, hospitals, schools, hotels, theatres, etc.

Current Guidance

The current guidance in the regulations BS8300:2009 is that adequate visual contrast is provided if the Light Reflectance Value (LRV) of the contrasting areas exceeds 30 points, “i.e., the contrast between the stair edging and the floor covering”. The testing equipment used to assess the LRV of C.A.T. product finishes is an integrated sphere spectrophotometer.





3. Slip Resistant Values (SRV's)

Research by BRE referenced in BS 8300-2:2018 demonstrates that when a stair tread depth is below 300mm the risk of overstepping is increased. Installing a suitable stair nosing will increase the slip resistance at the step edge.

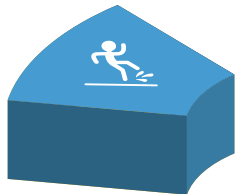

C.A.T. manufacture a unique castellated PVC infill that maximises the overall slip resistance and provides an excellent SRV and PTV.

C.A.T. stair nosing infills and treads have been independently tested for slip resistance values (SRV). For use in dry conditions, all our stair nosings and infill test results show a low risk of slip, contributing to the overall safety aspect of interior staircase installations.

We also manufacture a range of purpose-designed stair nosings for use in external or wet areas, which also provide a low risk of slip in wet conditions.

The values published are for the normal direction of travel when installed on stairs, i.e., ascending and descending. It must be noted that many factors will contribute to the safety of stairs, not solely the floor covering or the stair nosing fitted.

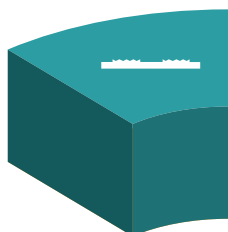

4. Nosing Channel Infill Options

As standard, C.A.T. provides a unique range of castellated Aluminium, Brass and PVC inserts which offer a higher slip resistant value (SRV) compared to smooth textured PVC inserts.

With a choice of 19 colours in PVC and a variety of finishes available on our aluminium or brass inserts - C.A.T. have a wide choice of options to highlight a step edge, meet design intent and fulfil LRV regulations.

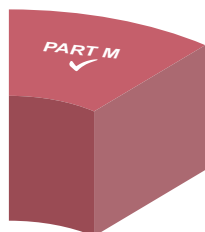

5. Legislation & Standards

The following legislation and standards relate to the specification and use of stair nosings:

- Building Regulations 2010 - Approved Documents K and M
- BS 8300-2:2018 - Design of an accessible and inclusive built environment.
- BS 5395-1:2010 - Code of practice for the design of stairs with straight flights and winders.
- BS 9266:2013 - Design of accessible and adaptable general needs housing.
- BS 8493:2008+A1:2010 - Light reflectance value (LRV) of a surface.

6. Fixings & Technique

C.A.T. recommends that all nosing profiles are fixed with screws and adhesive. We offer a choice of fixing methods.

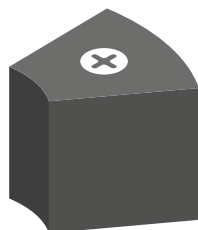

Retrofit Option

When installing stair nosings with PVC, aluminium or brass infills retrofit offers a neat concealed fixing. Retrofit nosings are supplied cut to size with a pre-drilled channel for countersunk screw fixings and a pre-taped infill.

Drilled Option

Stair nosings are supplied pre-drilled and affixed with screws, plugs (PVC Infill Only) and cartridge adhesive.

When using adhesive C.A.T. recommend the use of Stycco Flex rapid curing flexible adhesive from F.Ball & Co. Please contact the sales office for details. When adhesive only is used, ensure adequate cure time is allowed before allowing pedestrian access to the step(s).



Guide to Floor Finishing Trims

Over the last 35 years the type and number of floor finishing trims available within the market has grown from 15 commonly used profiles in 3 finishes to more than 400. This has been due to an ever-increasing variety of flooring on the market as well as more demanding requirements by interior designers, architects, and specifiers.

C.A.T. has led the way, innovating and responding to the needs of the industry, creating imaginative, attractive, functional solutions and always keeping quality in mind.

Floor finishing trims are known by various names and familiarising yourself with the following will assist you in understanding the products and their uses.

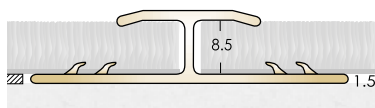

Double Naplock / Twingrip / Double Doorbar

Threshold Plate, usually used to join 2 carpets in a doorway.

Examples of C.A.T. products: Feline 2 (brass), Feline A/9/2 (aluminium)

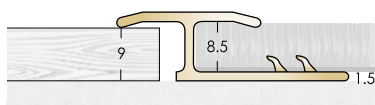

Single Leg / Z Edge, for finishing carpets to hard floors at the same level.

Examples of C.A.T. products: Feline 1 (brass), Feline A/10 (aluminium)

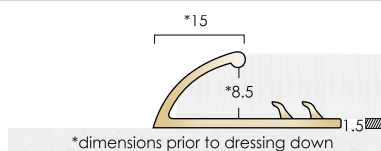

Single Naplock / Single Doorbar, for finishing carpets to resilient floors at different levels. Examples of C.A.T. products: BNF (brass), ANF (aluminium)

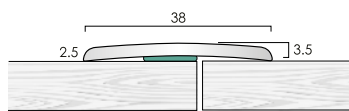

Cover Plate / Cover Strip, to cover the joint between two hard floors at the same height. Can be supplied drilled or undrilled with Stick-fix tape pre applied.. Examples of C.A.T. products: BC38 (brass), AC38 (aluminium).

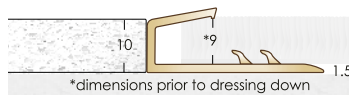

Square Edge, often used for finishing carpets to hard floors of the same height, creating matwells or edging floor traps. Examples of C.A.T. products: Feline Edge.

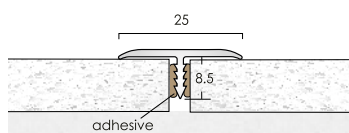

T Profiles, fitted to cover joints between hard floors such as stone and timber. Examples of C.A.T. products: Feline AT25, Feline T14.

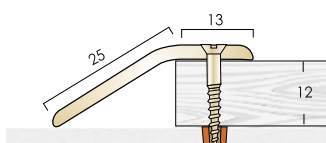

Ramp Profiles, trims used to transition between floor finishes of different heights. Stick-Fix or screw down options. Examples of C.A.T. products: AR8, BR8, AR63 plus many others.

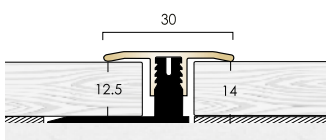

Clip in Profiles, these are trim systems where a base profile is fitted between flooring materials and a top profile is clipped into the base. Originally used to cover expansion joints in timber floors but now used in many different situations. A concealed fixing system, available as twin tops or ramps. Examples of C.A.T. products are Kliks, Kliks Slim and Kliks Spectrum.

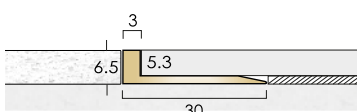

Angle Edge and Tag Trim. Angles are fitted as a neat definition between 2 floor finishes. Tag Trim is the formable version of an angle edge which can be curved on site and is used to make curved outlines in the flooring. We make these profiles with upstands in various heights, from 4.5mm to 25mm. The top edge of the upstand is usually 3mm thick on aluminium and brass angles, 2.4mm on stainless steel. We also offer angles with 6mm and 6.5mm top edges as shown in our Mainline and B6 Brass Capped products.



Flooring Profiles

Aluminium, Brass
& Stainless Steel





Special Finishes

A selection of C.A.T. flooring profiles are available with special finishes.

For information on the availability of a finish on a particular product please refer to the relevant product page in this catalogue.

Should you require further assistance, please contact the C.A.T. sales office.

Finishes depicted in this catalogue are representative only and are subject to print interpretation. For accurate referencing, please request a sample from the C.A.T. sales office.

In 1999 we pioneered special finishes on brass thresholds in antique and chrome finishes and again in 2016 developed our Designer Home Collection range of special finishes on aluminium profiles for the residential and light commercial market. We are constantly developing our range and finishes to provide our customers with a byword at C.A.T; Choice.

Brass Finishes

Antique Brass and Antique Bronze finishes are a chemically applied process to Brass products and are hand finished with a variance from batch to batch. Antique finishes are not foot traffic resistant and are designed to create an aged, unpolished effect.



Polished Brass

Satin Brass

Antique Brass

Antique Bronze

Aluminium Finishes



Mill

Bright

Satin

DESIGNER HOME COLLECTION

available on Feline A/9/2, Feline A/10, Feline A12Z, AR3 SF, AR6 SF, ANF, AC38, Kliks Slim Twin Top & Ramp Top, Feline AT25, AN20/3 and AN21/3.



Light Bronze

Bronze

Bright

Pewter

Onyx

Piano Black

Brushed Stainless

Designer Satin

Designer Home Collection finishes are anodised finishes and shades can vary from batch to batch.

Chrome Plated Finishes On Brass

Plated finishes are not solid metals and consideration should be given when selection takes place as to the suitability of the product in the installation.



Chrome

Satin Chrome

Stainless Steel Finishes



Bright

Brushed



Samples Available



DESIGNER
HOME COLLECTION

Aluminium Profiles



Feline A/10 Bright



Quick Reference Guide

DESIGNER

HOME COLLECTION

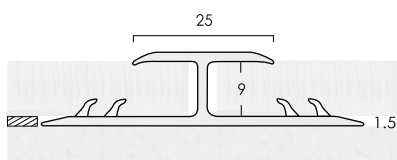

FELINE A/9/2 DHC

See page 21

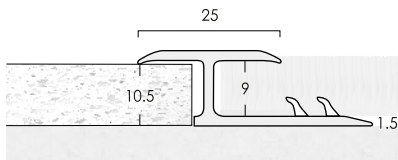

FELINE A/10 DHC

See page 22

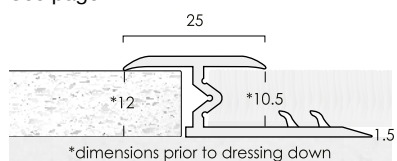

FELINE A/12Z DHC

See page 22

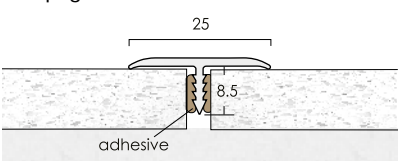

FELINE AT25 DHC

See page 24

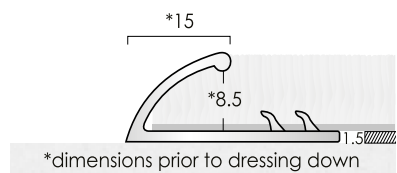

ANF DHC

See page 25

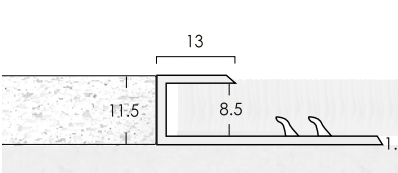

CAP IT DHC

See page 25

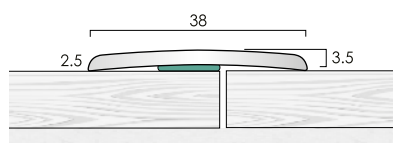

AC38 DHC SF

See page 26

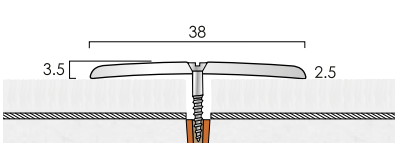

AC38 DHC

See page 46



AR3 SF DHC

See page 27



KLIK SLIM TWIN TOP

See page 81

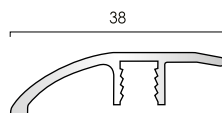

KLIK SLIM RAMP TOP

See page 82

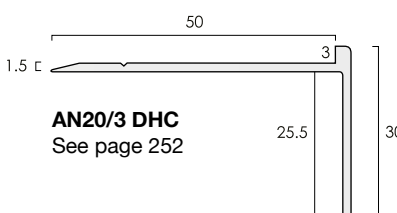

AN20/3 DHC

See page 252

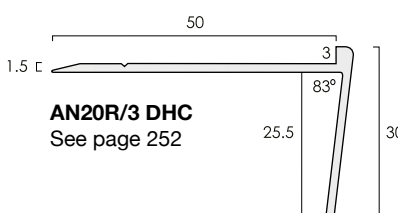

AN20R/3 DHC

See page 252

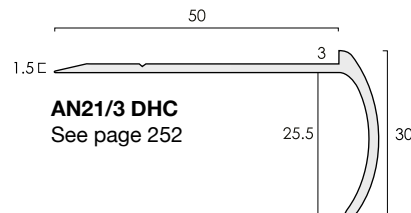

AN21/3 DHC

See page 252

Profiles shown approximately 75% scale. Finishes shown for representation only.

Designer Home Collection finishes are anodised finishes and shades can vary from batch to batch.



Feline™ Twin Top - Twin Leg Flooring Profiles

Joining profiles for carpet to carpet installations. Feline trims are designed with a smooth, attractive, high quality surface finish.

DESIGNER HOME COLLECTION

FELINE A/9/2 DHC

Aluminium

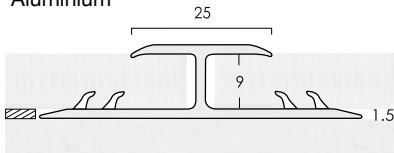

Twin base profile for
carpet to carpet installations

FELINE A/9/2 DHC

DESIGNER FINISHES FOR DESIGNER FLOORS

Finishes Available	Stock Length	Length/Tube
Brushed Stainless	0.900m	6
	2.715m	6
Bright	0.900m	6
	2.715m	6
Bronze	0.900m	6
	2.715m	6
Light Bronze	0.900m	6
	2.715m	6
Pewter	0.900m	6
	2.715m	6
Onyx	0.900m	6
	2.715m	6
Piano Black	0.900m	6
	2.715m	6
Designer Satin	0.900m	6
	2.715m	6

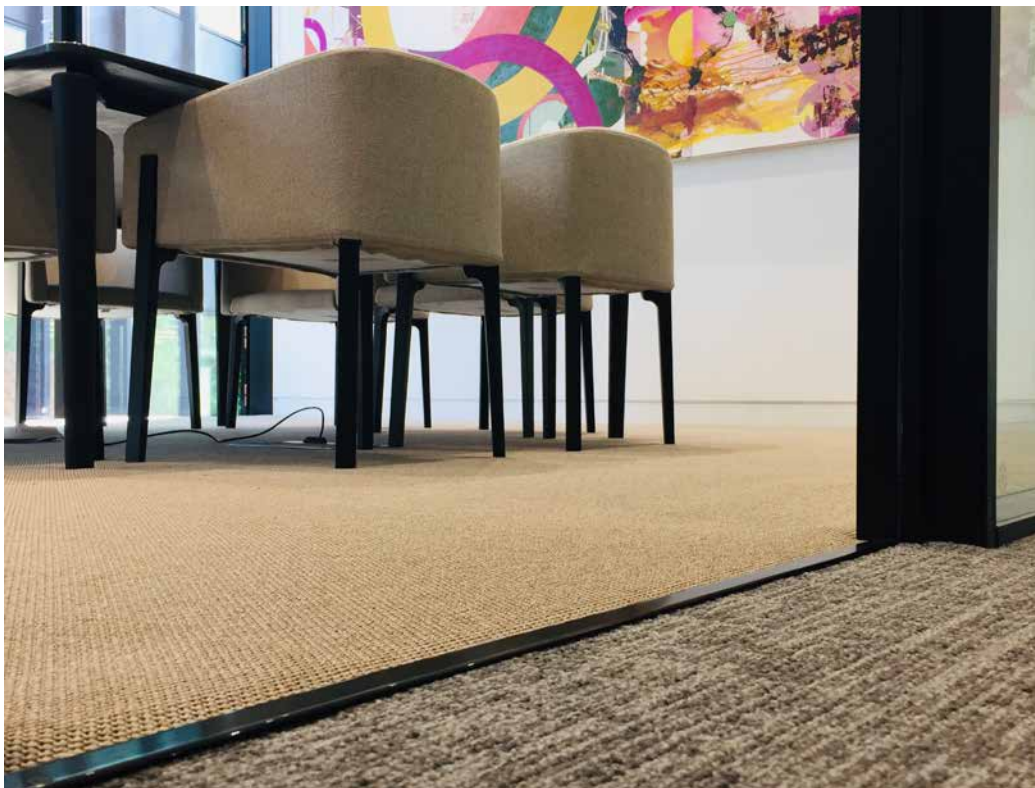

DHC Designer Finishes:



Brushed Stainless Bright



Bronze



Light Bronze



Pewter



Onyx



Piano Black



Designer Satin



Samples Available

Fixings not supplied

Designer Home Collection finishes are anodised finishes and shades can vary from batch to batch.



Feline™ Twin Top - Single Leg Flooring Profiles

Joining profiles for carpet to stone, timber and ceramic transitions where the flooring meets at the same level. Trim heights can be increased with suitable packers.

DESIGNER HOME COLLECTION

FELINE A/10 DHC

Aluminium

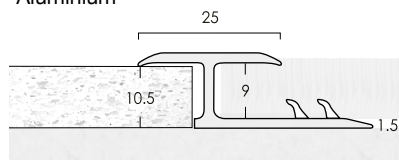

DESIGNER HOME COLLECTION

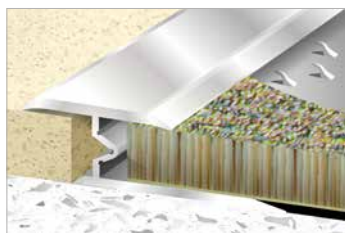

FELINE A/12Z DHC

Aluminium

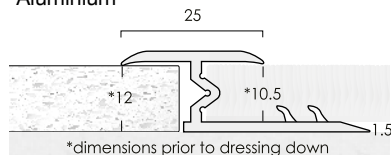

Collapsible centre leg to accommodate minor differences in floor levels.

FELINE A/10 DHC

DESIGNER FINISHES FOR DESIGNER FLOORS

Finishes Available	Stock Length	Length/Tube
Brushed Stainless	0.900m	6
	2.715m	6
Bright	0.900m	6
	2.715m	6
Bronze	0.900m	6
	2.715m	6
Light Bronze	0.900m	6
	2.715m	6
Pewter	0.900m	6
	2.715m	6
Onyx	0.900m	6
	2.715m	6
Piano Black	0.900m	6
	2.715m	6
Designer Satin	0.900m	6
	2.715m	6

FELINE A/12Z DHC

DESIGNER FINISHES FOR DESIGNER FLOORS

Finishes Available	Stock Length	Length/Tube
Brushed Stainless	0.900m	6
	2.715m	6
Bright	0.900m	6
	2.715m	6
Bronze	0.900m	6
	2.715m	6
Light Bronze	0.900m	6
	2.715m	6
Pewter	0.900m	6
	2.715m	6
Onyx	0.900m	6
	2.715m	6
Piano Black	0.900m	6
	2.715m	6
Designer Satin	0.900m	6
	2.715m	6

DHC Designer Finishes:



Brushed Stainless



Bright



Bronze



Light Bronze



Pewter



Onyx



Piano Black



Designer Satin

Designer Home Collection finishes are anodised finishes and shades can vary from batch to batch.



Samples Available

Fixings not supplied

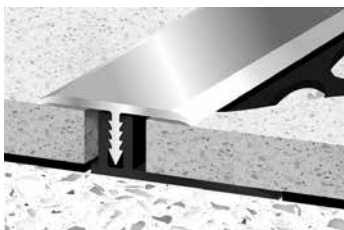

Feline™ T Flooring Profiles

T profile to protect the edge of stone and ceramic floors.

DESIGNER

HOME COLLECTION

FELINE AT25 DHC

Aluminium

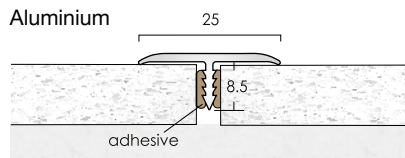

FELINE AT25 DHC

DESIGNER FINISHES FOR DESIGNER FLOORS

Finishes Available	Stock Length	Length/Tube
Brushed Stainless	0.900m	6
	2.715m	6
Bright	0.900m	6
	2.715m	6
Bronze	0.900m	6
	2.715m	6
Light Bronze	0.900m	6
	2.715m	6
Pewter	0.900m	6
	2.715m	6
Onyx	0.900m	6
	2.715m	6
Piano Black	0.900m	6
	2.715m	6
Designer Satin	0.900m	6
	2.715m	6

Feline AT25 flooring profiles can be used with uPVC base, if preferred:

T BASE 12 uPVC - adhesive fixing

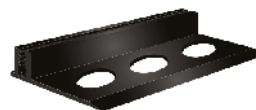

T BASE 12

Finish Available	Colour	Stock Length	Length/Tube
PVC	Black	2.715m	6

Standard Finish - Feline AT35:



Satin Aluminium

Feline AT25 DHC Designer Finishes:



Brushed Stainless



Bright



Bronze



Light Bronze



Pewter



Onyx



Piano Black



Designer Satin



Samples Available

Fixings not supplied

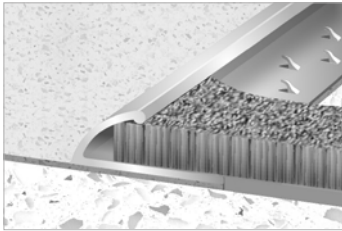

DESIGNER

HOME COLLECTION

ANF DHC

Aluminium

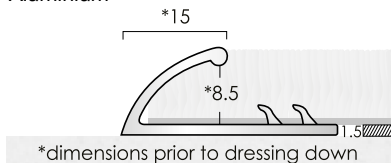

Single nap lock for
carpet to resilient flooring.

DESIGNER

HOME COLLECTION

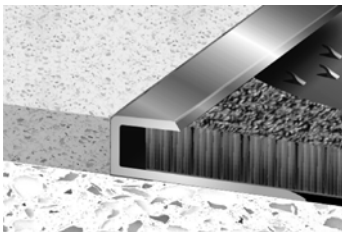

CAP IT DHC

Aluminium

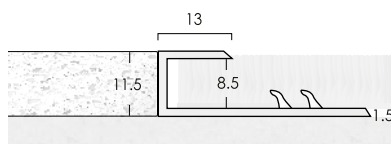

Square edge profiles provide a neat
trim edging where carpets and carpet tiles
meet with stone and ceramic flooring.



Single Nap Lock Flooring Profiles

For carpet to resilient floorings.

Single nap lock flooring profiles are designed to trap and protect the nap edge of the carpet when installed with resilient floorings.

ANF DHC

DESIGNER FINISHES FOR DESIGNER FLOORS

Finishes Available	Stock Length	Length/Tube
Brushed Stainless	0.900m	6
	2.715m	6
Bright	0.900m	6
	2.715m	6
Bronze	0.900m	6
	2.715m	6
Light Bronze	0.900m	6
	2.715m	6
Pewter	0.900m	6
	2.715m	6
Onyx	0.900m	6
	2.715m	6
Piano Black	0.900m	6
	2.715m	6
Designer Satin	0.900m	6
	2.715m	6

CAP IT DHC

DESIGNER FINISHES FOR DESIGNER FLOORS

Finishes Available	Stock Length	Length/Tube
Brushed Stainless	0.900m	6
	2.715m	6
Bright	0.900m	6
	2.715m	6
Bronze	0.900m	6
	2.715m	6
Light Bronze	0.900m	6
	2.715m	6
Pewter	0.900m	6
	2.715m	6
Onyx	0.900m	6
	2.715m	6
Designer Satin	0.900m	6
	2.715m	6

DHC Designer Finishes:



Brushed Stainless



Bright



Bronze



Light Bronze



Pewter



Onyx



Piano Black



Designer Satin



Samples Available

Fixings not supplied

Designer Home Collection finishes are anodised finishes and shades can vary from batch to batch.



Aluminium Cover Plates



Supplied undrilled with Stick-Fix tape pre-applied

- Mechanical fixing free - no screws installation
- No risk to underfloor cables and pipes
- Rapid install time

DESIGNER HOME COLLECTION

AC38 DHC SF

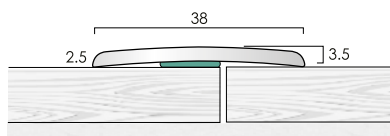

AC38 DHC SF DESIGNER FINISHES FOR DESIGNER FLOORS

Finishes Available	Screw Size	Length/Tube
Brushed Stainless	0.900m	6
	2.715m	6
Bright	0.900m	6
	2.715m	6
Bronze	0.900m	6
	2.715m	6
Light Bronze	0.900m	6
	2.715m	6
Pewter	0.900m	6
	2.715m	6
Onyx	0.900m	6
	2.715m	6
Piano Black	0.900m	6
	2.715m	6
Designer Satin	0.900m	6
	2.715m	6

AC55 SF

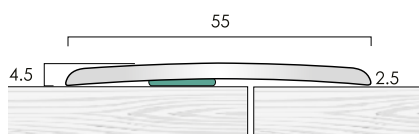

AC55 SF

Finishes Available	Screw Size	Length/Tube
Designer Satin	2.715m	6
Bright	2.715m	6

Standard Finishes - AC55 SF



Polished Aluminium Satin Aluminium

AC38 DHC SF Designer Finishes:



Brushed Stainless

Bright

Bronze

Light Bronze

Pewter

Onyx

Piano Black

Designer Satin



Samples Available

Fixings not supplied

Designer Home Collection finishes are anodised finishes and shades can vary from batch to batch.

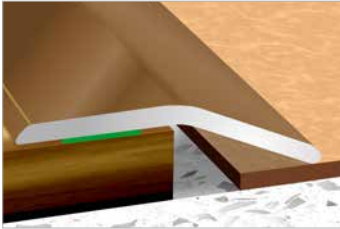

Aluminium Ramp Flooring Profiles

Supplied with pre-applied Stick-Fix tape.

DESIGNER HOME COLLECTION

AR3 SF DHC

Aluminium

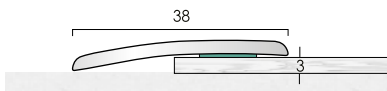

AR3 SF DHC

DESIGNER FINISHES FOR DESIGNER FLOORS

Finishes Available	Stock Length	Length/Tube
Brushed Stainless	0.900m	6
	2.715m	6
Bright	0.900m	6
	2.715m	6
Bronze	0.900m	6
	2.715m	6
Light Bronze	0.900m	6
	2.715m	6
Pewter	0.900m	6
	2.715m	6
Onyx	0.900m	6
	2.715m	6
Piano Black	0.900m	6
	2.715m	6
Designer Satin	0.900m	6
	2.715m	6

DESIGNER HOME COLLECTION

AR6 SF DHC

Aluminium

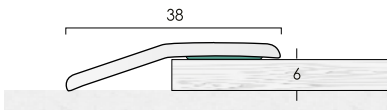

AR6 SF DHC

DESIGNER FINISHES FOR DESIGNER FLOORS

Finishes Available	Screw Size	Length/Tube
Brushed Stainless	0.900m	6
	2.715m	6
Bright	0.900m	6
	2.715m	6
Bronze	0.900m	6
	2.715m	6
Light Bronze	0.900m	6
	2.715m	6
Pewter	0.900m	6
	2.715m	6
Onyx	0.900m	6
	2.715m	6
Piano Black	0.900m	6
	2.715m	6
Designer Satin	0.900m	6
	2.715m	6

DHC Designer Finishes:



Brushed Stainless



Bright



Bronze



Light Bronze



Pewter



Onyx



Piano Black



Designer Satin



Samples Available

Fixings not supplied

Designer Home Collection finishes are anodised finishes and shades can vary from batch to batch.



Threshold Cover Plates

Aluminium, Brass
& Stainless Steel





look for the Stick-Fix™ logo



Aluminium Cover Plates

Supplied undrilled with Stick-Fix tape pre-applied

- Mechanical fixing free - no screws installation
- No risk to underfloor cables and pipes
- Rapid install time



DESIGNER
HOME COLLECTION

AC38 DHC SF

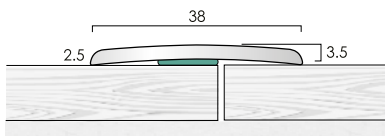

AC38 DHC SF DESIGNER FINISHES FOR DESIGNER FLOORS

Finishes Available	Screw Size	Length/Tube
Brushed Stainless	0.900m	6
	2.715m	6
Bright	0.900m	6
	2.715m	6
Bronze	0.900m	6
	2.715m	6
Light Bronze	0.900m	6
	2.715m	6
Pewter	0.900m	6
	2.715m	6
Onyx	0.900m	6
	2.715m	6
Piano Black	0.900m	6
	2.715m	6
Designer Satin	0.900m	6
	2.715m	6

AC55 SF

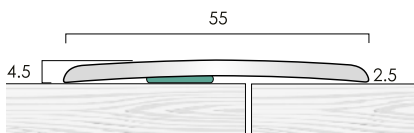

AC55 SF

Finishes Available	Screw Size	Length/Tube
Designer Satin	2.715m	6
Bright	2.715m	6

AC38 DHC SF Designer Finishes:



Brushed Stainless



Bright



Bronze



Light Bronze

Standard Finishes - AC55 SF & A155 SF:



Pewter



Onyx



Piano Black



Designer Satin



Polished Aluminium



Satin Aluminium

Designer Home Collection finishes are anodised finishes and shades can vary from batch to batch.



Samples Available

Fixings not supplied

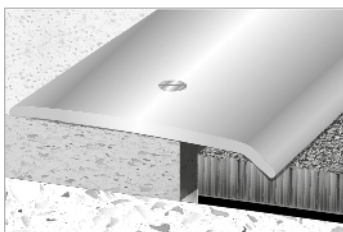

Aluminium Cover Plates

General purpose aluminium cover plates for various applications. Supplied drilled for mechanical fixings. Where not shown as standard supply, off-centre drilled, undrilled and centre drilled available to special order .

AC38 DHC

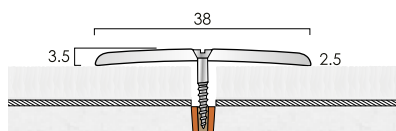

AC55

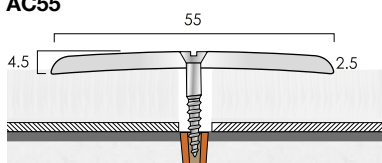

supplied centre drilled

AC38 DHC DESIGNER FINISHES FOR DESIGNER FLOORS

Finishes Available	Maximum Length	Screw Size	Length/Tube
Brushed Stainless	0.900m	6	6
	2.715m	6	6
Bright	0.900m	6	6
	2.715m	6	6
Bronze	0.900m	6	6
	2.715m	6	6
Light Bronze	0.900m	6	6
	2.715m	6	6
Pewter	0.900m	6	6
	2.715m	6	6
Onyx Black	0.900m	6	6
	2.715m	6	6
Piano Black	0.900m	6	6
	2.715m	6	6
Designer Satin	0.900m	6	6
	2.715m	6	6

AC55

Finish Available	Stock Length	Screw Size	Length/Tube
Designer Satin	2.715m	8	6
Bright	2.715m	8	6

AC38 DHC Designer Finishes:



Designer Home Collection finishes are anodised finishes and shades can vary from batch to batch.

Standard Finishes:



Mill Aluminium Polished Aluminium Satin Aluminium

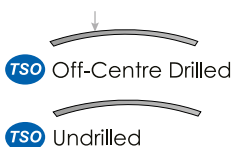

*To Special Order



Samples Available

Fixings not supplied

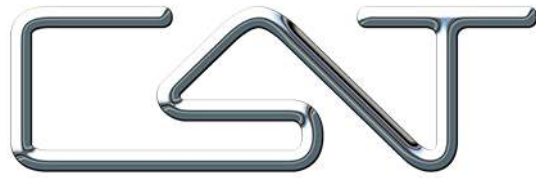

Ramp Profiles

Aluminium, Brass
& Stainless Steel



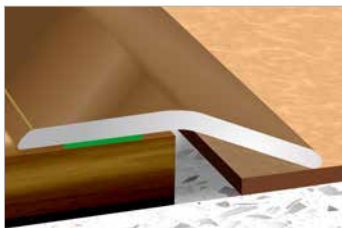

Aluminium Ramp Flooring Profiles

Supplied with pre-applied Stick-Fix tape.

DESIGNER HOME COLLECTION

AR3 SF DHC

Aluminium

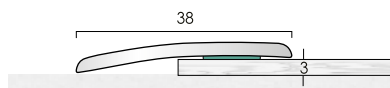

AR3 SF DHC

DESIGNER FINISHES FOR DESIGNER FLOORS

Finishes Available	Stock Length	Length/Tube
Brushed Stainless	0.900m	6
	2.715m	6
Bright	0.900m	6
	2.715m	6
Bronze	0.900m	6
	2.715m	6
Light Bronze	0.900m	6
	2.715m	6
Pewter	0.900m	6
	2.715m	6
Onyx	0.900m	6
	2.715m	6
Piano Black	0.900m	6
	2.715m	6
Designer Satin	0.900m	6
	2.715m	6

DESIGNER HOME COLLECTION

AR6 SF DHC

Aluminium

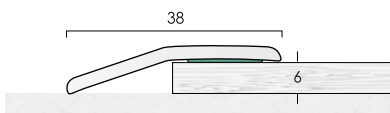

AR6 SF DHC

DESIGNER FINISHES FOR DESIGNER FLOORS

Finishes Available	Screw Size	Length/Tube
Brushed Stainless	0.900m	6
	2.715m	6
Bright	0.900m	6
	2.715m	6
Bronze	0.900m	6
	2.715m	6
Light Bronze	0.900m	6
	2.715m	6
Pewter	0.900m	6
	2.715m	6
Onyx	0.900m	6
	2.715m	6
Piano Black	0.900m	6
	2.715m	6
Designer Satin	0.900m	6
	2.715m	6

DHC Designer Finishes:



Brushed Stainless



Bright



Bronze



Light Bronze



Pewter



Onyx



Piano Black



Designer Satin



Samples Available

Fixings not supplied

Designer Home Collection finishes are anodised finishes and shades can vary from batch to batch.

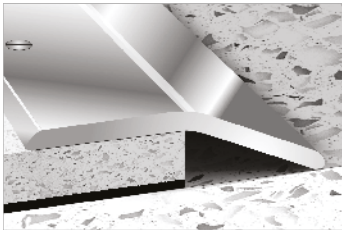

Aluminium Ramp Flooring Profiles

Finishing ramp trims where floors adjoin at different levels.
Supplied drilled for mechanical fixings.

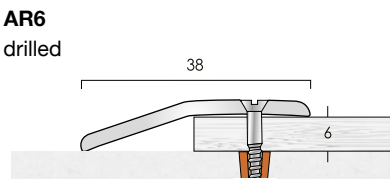
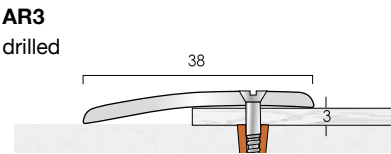

AR3

Finishes Available	Stock Length	Screw Size	Length/Tube
Designer Satin DHC	2.715m	6	6
Bright DHC	2.715m	6	6

AR6

Finishes Available	Stock Length	Screw Size	Length/Tube
Designer Satin DHC	2.715m	6	6
Bright DHC	2.715m	6	6

DHC Designer Finishes:



Bright



Designer Satin

Standard Finish:



Satin Aluminium

Designer Home Collection finishes are anodised finishes and shades can vary from batch to batch.



Samples Available

Fixings not supplied

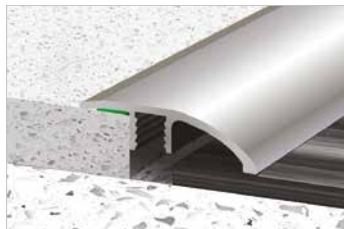

DESIGNER

HOME COLLECTION

Kliks SLIM RAMP DHC

Stick-Fix option - no base

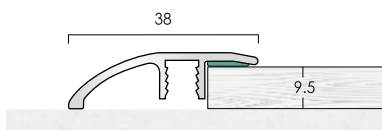

Kliks RAMP SF

Stick-Fix option - no base

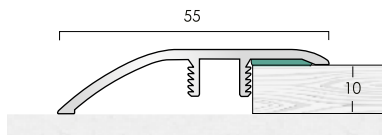

Kliks™ Aluminium Ramp Flooring Profiles

look for the Stick-Fix™ logo



Supplied undrilled with Stick-Fix tape pre-applied.

- Mechanical fixing free - no screws installation
- No risk to underfloor cables and pipes
- Rapid install time



Kliks SLIM RAMP DHC

DESIGNER FINISHES FOR DESIGNER FLOORS

Finishes Available	Stock Length	Length/Tube
Brushed Stainless	2.715m	6
Bright	2.715m	6
Bronze	2.715m	6
Light Bronze	2.715m	6
Pewter Onyx	2.715m	6
Piano Black	2.715m	6
Designer Satin	2.715m	6

KK123 SF

Finish Available	Stock Length	Length/Tube
Polished Aluminium	2.715m	6

KK133 SF

Finish Available	Stock Length	Length/Tube
Stain Aluminium	2.715m	6

Kliks™ aluminium ramp profiles are also available with a range of uPVC clip in bases. Please refer to the Kliks™ section of this catalogue for details.

DHC Designer Finishes:



Brushed Stainless



Bright



Bronze



Light Bronze



Pewter



Onyx



Designer Satin

Designer Home Collection finishes are anodised finishes and shades can vary from batch to batch.

Standard Finishes:



Polished Aluminium



Satin Aluminium



Samples Available

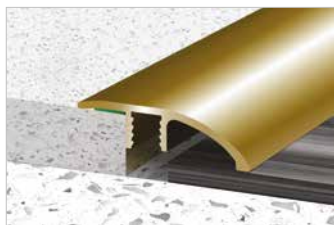

look for the Stick-Fix™ logo



Kliks™ Solid Brass Ramp Flooring Profiles

Supplied undrilled with Stick-Fix tape pre-applied.

- Mechanical fixing free - no screws installation
- No risk to underfloor cables and pipes
- Rapid install time



Available in 38mm and 55mm widths, Kliks ramp profiles provide a neat transition between floorings at different 9-10mm levels - ceramic floors.

Kliks SLIM RAMP SF

Stick-Fix option - no base

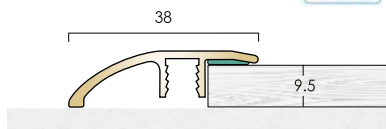

Finishes Available	Gauge	Stock Length	Length/Tube
KKSLR3 SF			
Polished Brass	2.5mm	0.900m	6
	2.5mm	2.715m	6
KKSLR301 SF			
Satin Brass	2.5mm	0.900m	6
	2.5mm	2.715m	6
KKSLR203 SF			
Antique Brass	2.5mm	0.900m	6
	2.5mm	2.715m	6
KKSLR213 SF			
Antique Bronze	2.5mm	0.900m	6
	2.5mm	2.715m	6
KKSLR223 SF			
Chrome	2.5mm	0.900m	6
	2.5mm	2.715m	6
KKSLR243 SF			
Satin Chrome	2.5mm	0.900m	6
	2.5mm	2.715m	6

Kliks RAMP SF

Stick-Fix option - no base

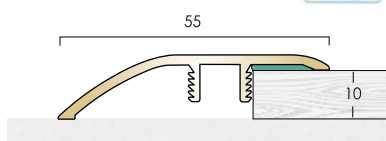

Finishes Available	Gauge	Stock Length	Length/Tube
KK3 SF			
Polished Brass	2.5mm	2.715m	6
KK301 SF			
Satin Brass	2.5mm	2.715m	6
KK203 SF			
Antique Brass	2.5mm	2.715m	6
KK213 SF			
Antique Bronze	2.5mm	2.715m	6
KK223 SF			
Chrome	2.5mm	2.715m	6

Finishes:



Polished Brass



Satin Brass



Antique Brass



Antique Bronze



Chrome



Satin Chrome



Samples Available

Fixings not supplied



Kliks™

Clip In Flooring Profiles System
Aluminium, Brass, Stainless Steel & uPVC





Clip In Systems

In this section you will find information on flooring profiles with a system where the base is fixed to the subfloor prior to the flooring being laid and finally the top profile being fitted into the base finishing the installation.

Kliks™ Primary Application: Commercial Environments

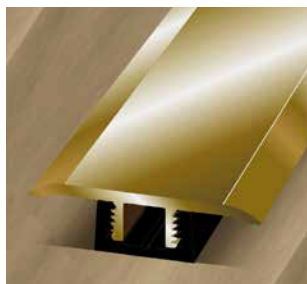

Comprising twin, ramp and end-stop profiles in a variety of metals and finishes

including:

- Brass
- Aluminium
- Chrome
- Antique

Suitable with:

- Timber
- Stone
- Ceramics
- Carpet

Height adjustable uPVC bases.

Kliks Slim™ Primary Application: High-End Residential and Light Commercial Environments



Comprising slim style twin, ramp and stop-end profiles in a variety of metals and finishes

including:

- Brass
- Aluminium
- Chrome
- Antique

Suitable with:

- Laminates
- Stone
- Ceramics
- Carpet

Aluminium and uPVC bases.

Kliks™ Spectrum Zip Primary Application: Commercial and Retail Environments



Formable into curves on site with uPVC bases.

Comprising twin, ramp and end-stop profiles in a wide selection of colours.

Suitable with:

- Timber
- Stone
- Ceramics
- Carpet

Height adjustable uPVC bases. Aluminium bases for carpet installations.



85% Recycled factory waste streams



Samples Available



Kliks™ Clip In Flooring Profiles System

Examples Of Tops & Bases Combinations

Twin top joining profiles

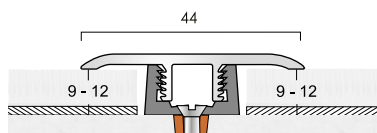

Kliks Twin Top
with
KB1 Base

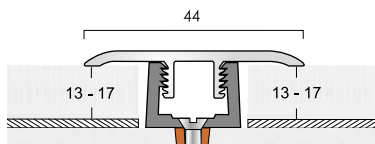

Kliks Twin Top
with
KB2 Base

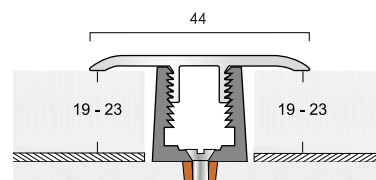

Kliks Twin Top
with
KB3 Base

End stop for wall perimeter finishing profiles

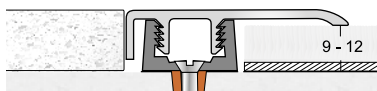

Kliks End Stop
with
KB1 Base

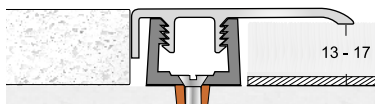

Kliks End Stop
with
KB2 Base

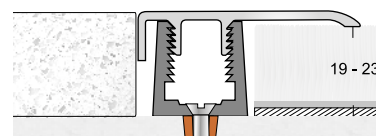

Kliks End Stop
with
KB3 Base

For junctions where floors are at different levels

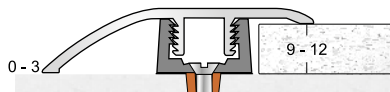

Kliks Ramp
with
KB1 Base

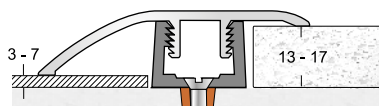

Kliks Ramp
with
KB2 Base

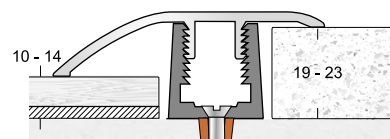

Kliks Ramp
with
KB3 Base

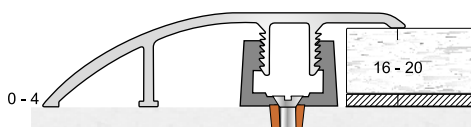

Kliks Large Ramp
with
KB2 Base

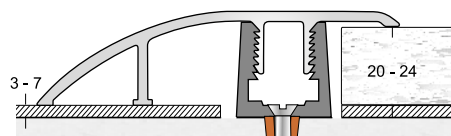

Kliks Large Ramp
with
KB3 Base



Samples Available

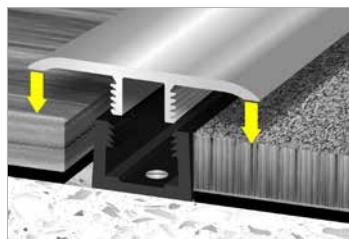

Base shown with Kliks Twin Top



Kliks™ Clip In Flooring Profiles System - Bases

uPVC bases for Kliks tops, supplied pre-drilled. Select base dependent upon height of floor covering. Bases have interlocking barb design for height adjustment when tops are secured.



KB1, KB2, & KB3 profiles contain up to
85% Recycled factory waste streams

KB1

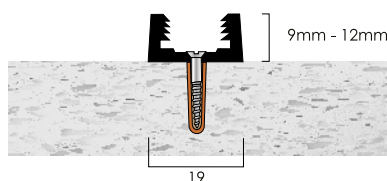

KB1

Colour	Stock Length	Screw Size	Length/Tube
Black	2.715m	6	6
Black	2.715m	6	50

KB2

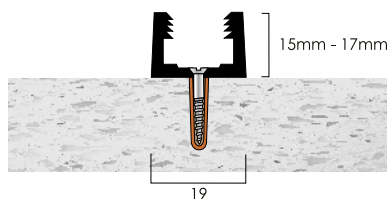

KB2

Colour	Stock Length	Screw Size	Length/Tube
Black	2.715m	6	6
Black	2.715m	6	50

KB3

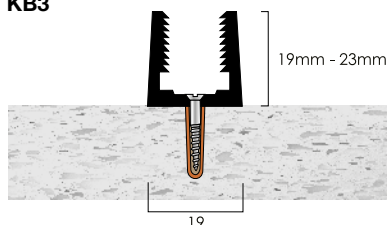

KB3

Colour	Stock Length	Screw Size	Length/Tube
Black	2.715m	6	6
Black	2.715m	6	50

Method of Installation:

A: Subfloor

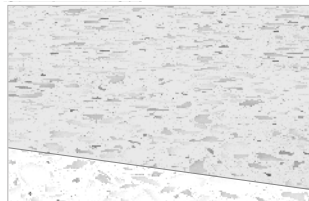

B: Base fitted

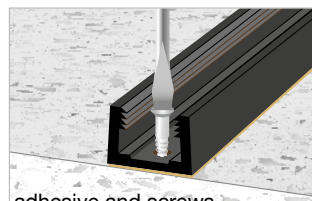

C: Flooring fitted to base

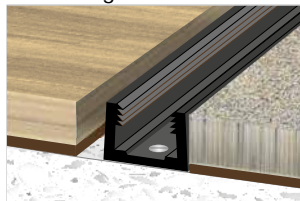

D: Top fitted into base



Base shown installed with Kliks Twin Top



Samples Available

Fixings not supplied



Kliks Slim™ Clip In Flooring Profiles System

Neat • Slim • High End Finishes

For residential and commercial applications. Tops can be fitted into a wide range of bases to suit a wide variety of floorings.

Examples Of Tops & Bases Combinations

Twin top joining profiles



Kliks Slim Twin Top
with
KKSBP9.5 uPVC Base



Kliks Slim Twin Top
with
KKSBP12 uPVC Base



Kliks Slim Twin Top
with
KKSBP15 uPVC Base

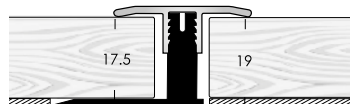

Kliks Slim Twin Top
with
KKSBP20 uPVC Base

End stop & wall perimeter finishing profiles

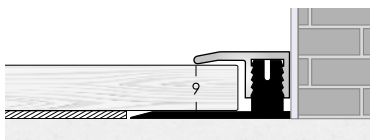

Kliks Slim End Stop
with
KKSBP12 uPVC Base
Compatible with other bases

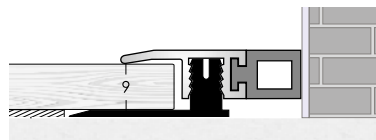

TSO Kliks Slim End Stop with Expansion/Compression Feature
with
KKSBP12 uPVC Base
Compatible with other bases

For junctions where floors are at different levels



Kliks Slim Ramp Top
with
KKSBP9.5 uPVC Base

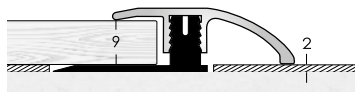

Kliks Slim Ramp Top
with
KKSBP12 uPVC Base

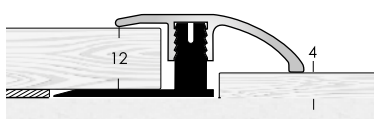

Kliks Slim Ramp Top
with
KKSBP15 uPVC Base

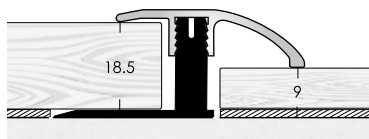

Kliks Slim Ramp Top
with
KKSBP20 uPVC Base



*To Special Order



Samples Available

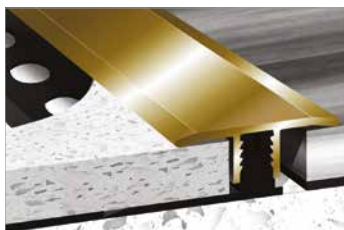

Kliks™ Slim Clip In Flooring Profiles System - Bases

For use with Kliks Slim Tops.

KKSBP9.5, 12, 15, & 20 profiles contain up to



85% Recycled factory waste streams

uPVC bases with punched slots for adhesive fixing. Suitable for stone, ceramic and laminate/timber floors.

KKSBP9.5

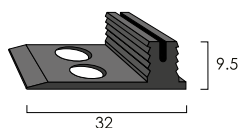

KKSBP9.5

Colour	Stock Length	Screw Size	Length/Tube
Black	0.900m	6	6
Black	2.715m	6	6

KKSBP12

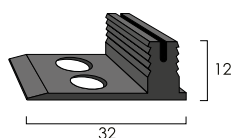

KKSBP12

Colour	Stock Length	Screw Size	Length/Tube
Black	0.900m	6	6
Black	2.715m	6	6

KKSBP15

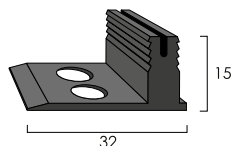

KKSBP15

Colour	Stock Length	Screw Size	Length/Tube
Black	0.900m	6	6
Black	2.715m	6	6

KKSBP20

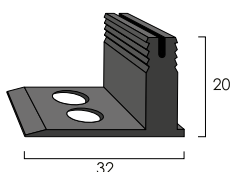

KKSBP20

Colour	Stock Length	Screw Size	Length/Tube
Black	0.900m	6	6
Black	2.715m	6	6

Method of Installation:

A: Subfloor

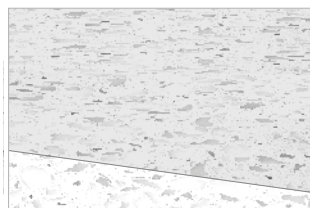

B: Base fitted



C: Flooring fitted to base



D: Top fitted into base



Samples Available

Fixings not supplied



Kliks™ Clip In Flooring Profiles System

Aluminium

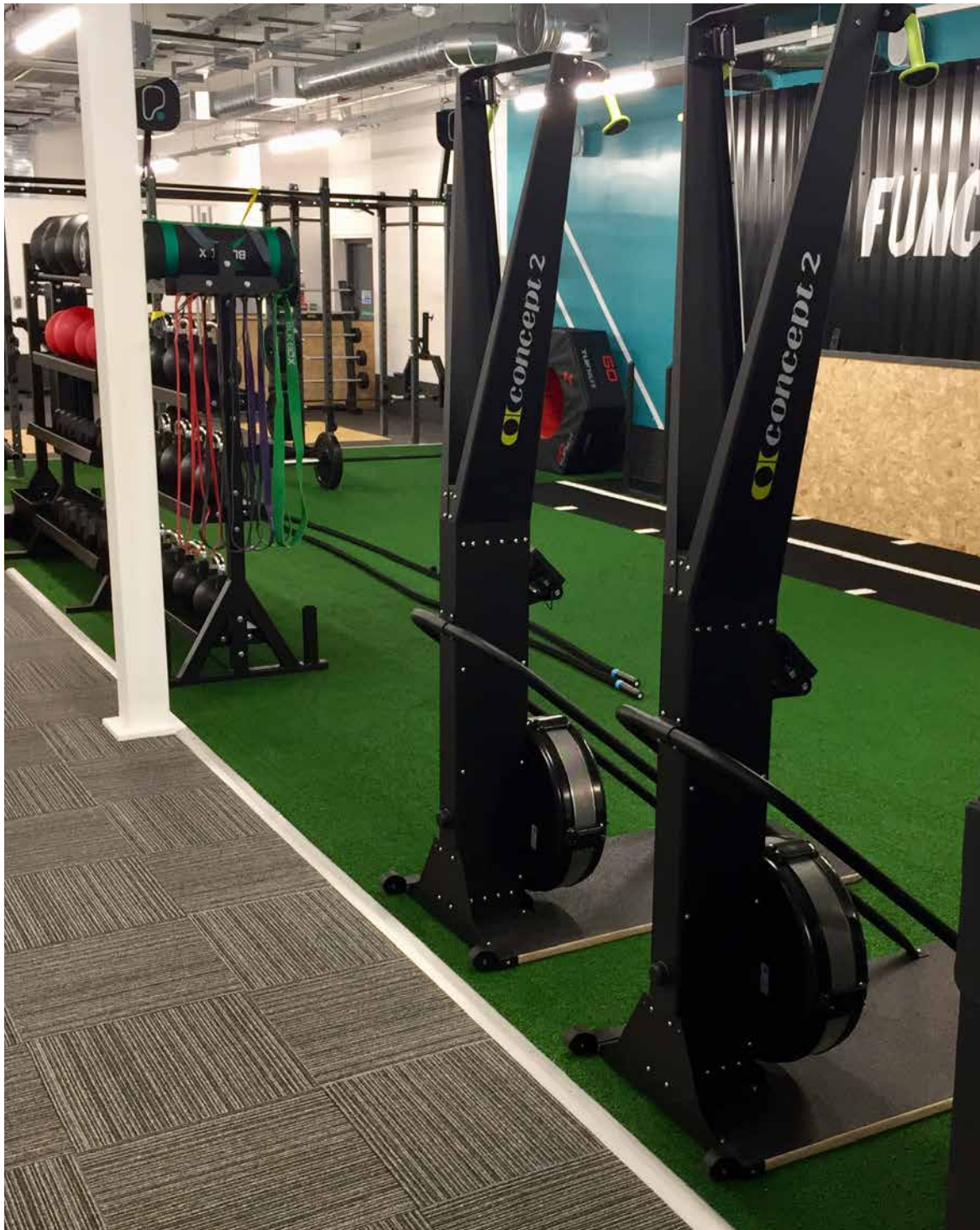

Product shown: KKSLR133



Kliks™ Clip In Flooring Profiles System Twin Tops

Kliks TWIN TOP

Aluminium

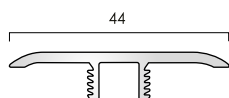

KK132

Finish Available	Stock Length	Length/Tube
Satin Aluminium	2.715m	6

KK122

Finish Available	Stock Length	Length/Tube
Polished Aluminium	2.715m	6

Install with uPVC Bases: KB1, KB2, KB3.

See page 77.



DESIGNER HOME COLLECTION

Kliks SLIM TWIN TOP

Aluminium

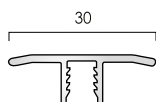

Kliks™ Slim Clip In Flooring Profiles System Twin Tops

KKSLTTDHC

DESIGNER FINISHES FOR DESIGNER

Finishes Available	Stock Length	Length/Tube
Brushed Stainless	2.715m	6
Bright	2.715m	6
Bronze	2.715m	6
Light Bronze	2.715m	6
Pewter	2.715m	6
Onyx Black	2.715m	6
Designer Satin	2.715m	6

Install with Kliks Slim Bases:

uPVC - KKSBP9.5, KKSBP12, KKSBP15, KKSBP20.

See page 79.

DHC Designer Finishes:



Brushed Stainless

Bright

Bronze

Light Bronze

Pewter

Onyx

Designer Satin

Designer Home Collection finishes are anodised finishes and shades can vary from batch to batch.

Standard Finishes:



Polished Aluminium

Satin Aluminium

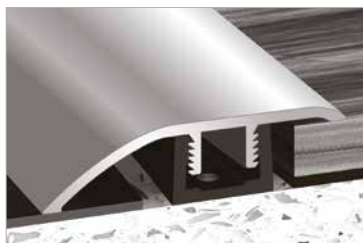
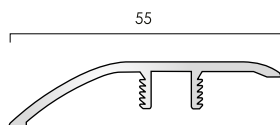

Samples Available

**Kliks RAMP TOP**

Kliks™ Clip In Flooring Profiles System Ramp Tops

KK133

Finish Available	Stock Length	Length/Tube
Satin Aluminium	2.715m	6

KK123

Finish Available	Stock Length	Length/Tube
Polished Aluminium	2.715m	6

Install with uPVC Bases: KB1, KB2, KB3. See page 77.

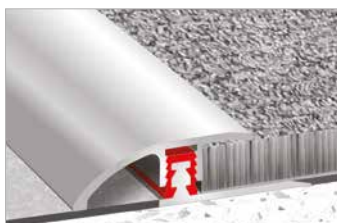

DESIGNER HOME COLLECTION

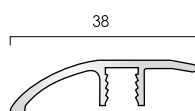
Kliks SLIM RAMP TOP

Kliks™ Slim Clip In Flooring Profiles System Ramp Tops

KKSLRDHC**DESIGNER FINISHES FOR DESIGNER FLOORS**

Finishes Available	Stock Length	Length/Tube
Brushed Stainless	2.715m	6
Bright	2.715m	6
Bronze	2.715m	6
Light Bronze	2.715m	6
Pewter	2.715m	6
Onyx Black	2.715m	6
Designer Satin	2.715m	6

Install with Kliks Slim Bases:

uPVC - KKSBP9.5, KKSBP12, KKSBP15, KKSBP20.

See page 79.

DHC Designer Finishes:

Brushed Stainless Bright Bronze Light Bronze Pewter Onyx Designer Satin

Designer Home Collection finishes are anodised finishes and shades can vary from batch to batch.

Standard Finishes:

Polished Aluminium Satin Aluminium



Samples Available



Kliks™

Clip In Flooring Profiles System Brass

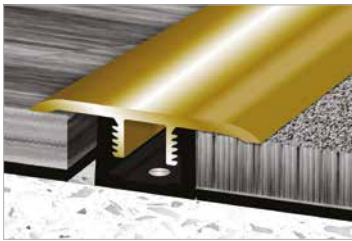

**Kliks TWIN TOP**

Brass

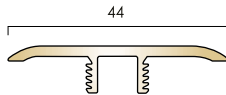

Install with uPVC Bases: KB1, KB2, KB3.
See page 77.

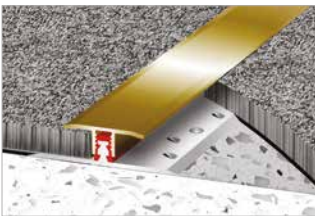
**Kliks SLIM TWIN TOP**

Brass

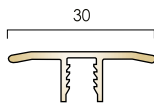





Install with Kliks Slim Bases:
uPVC - KKSBP9.5, KKSBP12,
KKSBP15, KKSBP20.
See page 79.



Kliks™ Clip In Solid Brass High Quality Flooring Profiles System Twin Tops



Finishes Available	Stock Length	Length/Tube
KK2		
Polished Brass	2.715m	6
KK201		
Satin Brass 	2.715m	6
KK202		
Antique Brass 	2.715m	6
KK212		
Antique Bronze 	2.715m	6
KK222		
Chrome 	2.715m	6

Kliks Slim™ Clip In Solid Brass High Quality Flooring Profiles System Twin Tops

Finishes Available	Stock Length	Length/Tube
KKSL2		
Polished Brass	0.900m	6
	2.715m	6
KKSL201		
Satin Brass 	0.900m	6
	2.715m	6
KKSL20		
Antique Brass 	0.900m	6
	2.715m	6
KKSL21		
Antique Bronze 	0.900m	6
	2.715m	6
KKSL22		
Chrome	0.900m	6
	2.715m	6
KKSL42		
Satin Chrome	0.900m	6
	2.715m	6

Finishes:

Polished Brass



Satin Brass



Antique Brass



Antique Bronze

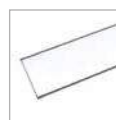

Chrome



Satin Chrome



*To Special Order



Samples Available

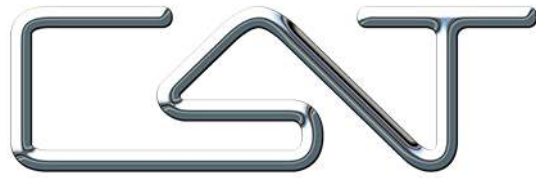

KliksTM

Clip In Flooring Profiles System

Stainless Steel



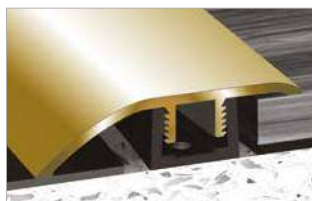

Kliks™ Clip In Solid Brass High Quality Flooring Profiles System Ramp Tops

Kliks RAMP TOP

Brass

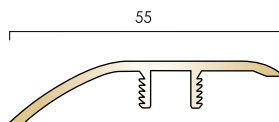

Finishes Available Stock Length Length/Tube

KK3

Polished Brass 2.715m 6

KK301

Satin Brass  2.715m 6

KK203

Antique Brass  2.715m 6

KK213

Antique Bronze  2.715m 6

KK223

Chrome  2.715m 6

Install with uPVC Bases: KB1, KB2, KB3. See page 77.

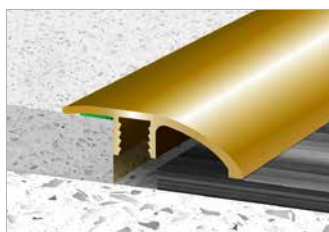

Kliks SLIM RAMP TOP

Brass

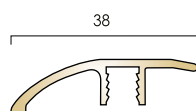

Kliks Slim™ Clip In Solid Brass High Quality Flooring Profiles System Ramp Tops

Finishes Available Stock Length Length/Tube

KKSLR3

Polished Brass 0.900m 6

2.715m 6

KKSLR301

Satin Brass  0.900m 6

 2.715m 6

KKSLR203

Antique Brass  0.900m 6

 2.715m 6

KKSLR213

Antique Bronze  0.900m 6

 2.715m 6

KKSLR223

Chrome 0.900m 6

2.715m 6

KKSLR243

Satin Chrome 0.900m 6

2.715m 6

Install with Kliks Slim Bases:

uPVC - KKSBP9.5, KKSBP12, KKSBP15, KKSBP20.

See page 79.

Finishes:



Polished Brass



Satin Brass



Antique Brass



Antique Bronze

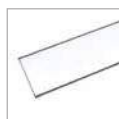

Chrome



Satin Chrome



*To Special Order

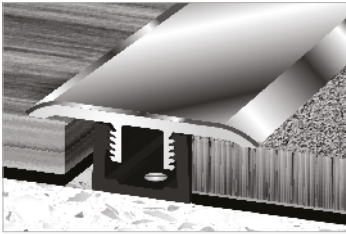

Samples Available

**Kliks TWIN TOP**

Aluminium with stainless steel top

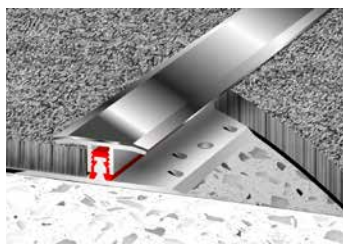
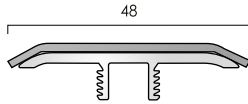
**Kliks SLIM TWIN TOP**

Aluminium with stainless steel top

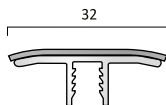
**Finishes:**

Bright Stainless Steel



Brushed Stainless Steel

**Kliks™ Clip In Flooring Profiles System Twin Tops**

Finishes Available	Stock Length	Length/Tube
--------------------	--------------	-------------

KK225

Bright Stainless Steel	2.500m	6
------------------------	--------	---

KK235

Brushed Stainless Steel	2.500m	6
-------------------------	--------	---

Install with uPVC Bases: KB1, KB2, KB3. See page 77.

Kliks Slim™ Clip In Flooring Profiles System Twin Tops

Finishes Available	Stock Length	Length/Tube
--------------------	--------------	-------------

KKSL225

Bright Stainless Steel	1.000m	6
------------------------	--------	---

Bright Stainless Steel	2.000m	6
------------------------	--------	---

KKSL235

Brushed Stainless Steel	1.000m	6
-------------------------	--------	---

Brushed Stainless Steel	2.000m	6
-------------------------	--------	---

Install with Kliks Slim Bases: uPVC - KKSBP9.5, KKSBP12, KKSBP15, KKSBP20. See page 79.



Samples Available



Capping Profiles





ALUMINIUM DESIGNER HOME COLLECTION

CAP IT

For carpet
and carpet tiles.

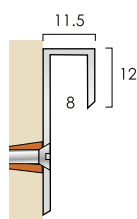

SOLID BRASS

BCAP IT

For carpet and
carpet tiles.

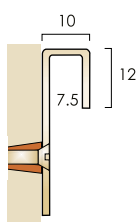

BCAP

For carpet and
carpet tiles.

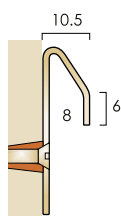

STAINLESS STEEL

SCAP

For vinyl and
linoleum flooring.

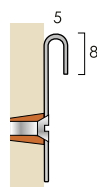

SSE

For carpet and
carpet tiles.

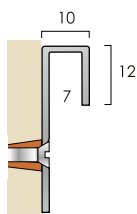

SSNF

For carpet and
carpet tiles.

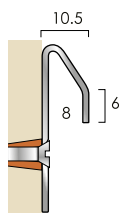

DHC Designer Finishes:



Brushed Stainless



Bright



Bronze



Light Bronze



Pewter



Onyx



Designer Satin

Designer Home Collection finishes are anodised finishes and shades can vary from batch to batch.

Standard Finishes:

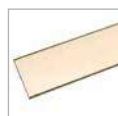

Polished Brass



Satin Brass



Antique Brass



Antique Bronze



Bright Stainless Steel



Brushed Stainless Steel



Capping Profiles



For installation on walls with floorings affixed where traditional skirtings are not preferred.

CAP IT DHC



DESIGNER FINISHES FOR DESIGNER FLOORS

Finishes Available	Stock Length	Screw size	Length/Tube
Brushed Stainless	2.715m	6	6
Bright	2.715m	6	6
Bronze	2.715m	6	6
Light Bronze	2.715m	6	6
Pewter	2.715m	6	6
Onyx	2.715m	6	6
Designer Satin	2.715m	6	6

BCAP IT

Finishes Available	Stock Length	Screw size	Length/Tube
Polished Brass	2.715m	6	6
Satin Brass 	2.715m	6	6
Antique Brass 	2.715m	6	6
Antique Bronze 	2.715m	6	6

BCAP

Finishes Available	Stock Length	Screw size	Length/Tube
Polished Brass	2.000m	6	6
Satin Brass 	2.000m	6	6
Antique Brass 	2.000m	6	6
Antique Bronze 	2.000m	6	6

SCAP

Finishes Available	Stock Length	Screw size	Length/Tube
Bright Stainless Steel	2.000m	6	6
Brushed Stainless Steel 	2.000m	6	6

SSE

Finishes Available	Stock Length	Screw size	Length/Tube
Bright Stainless Steel	2.000m	6	6
Brushed Stainless Steel 	2.000m	6	6

SSNF

Finishes Available	Stock Length	Screw size	Length/Tube
Bright Stainless Steel	2.000m	6	6
Brushed Stainless Steel 	2.000m	6	6



*To Special Order



Samples Available

Fixings not supplied

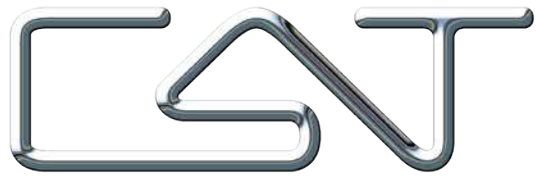

Stair Nosings & Edgings

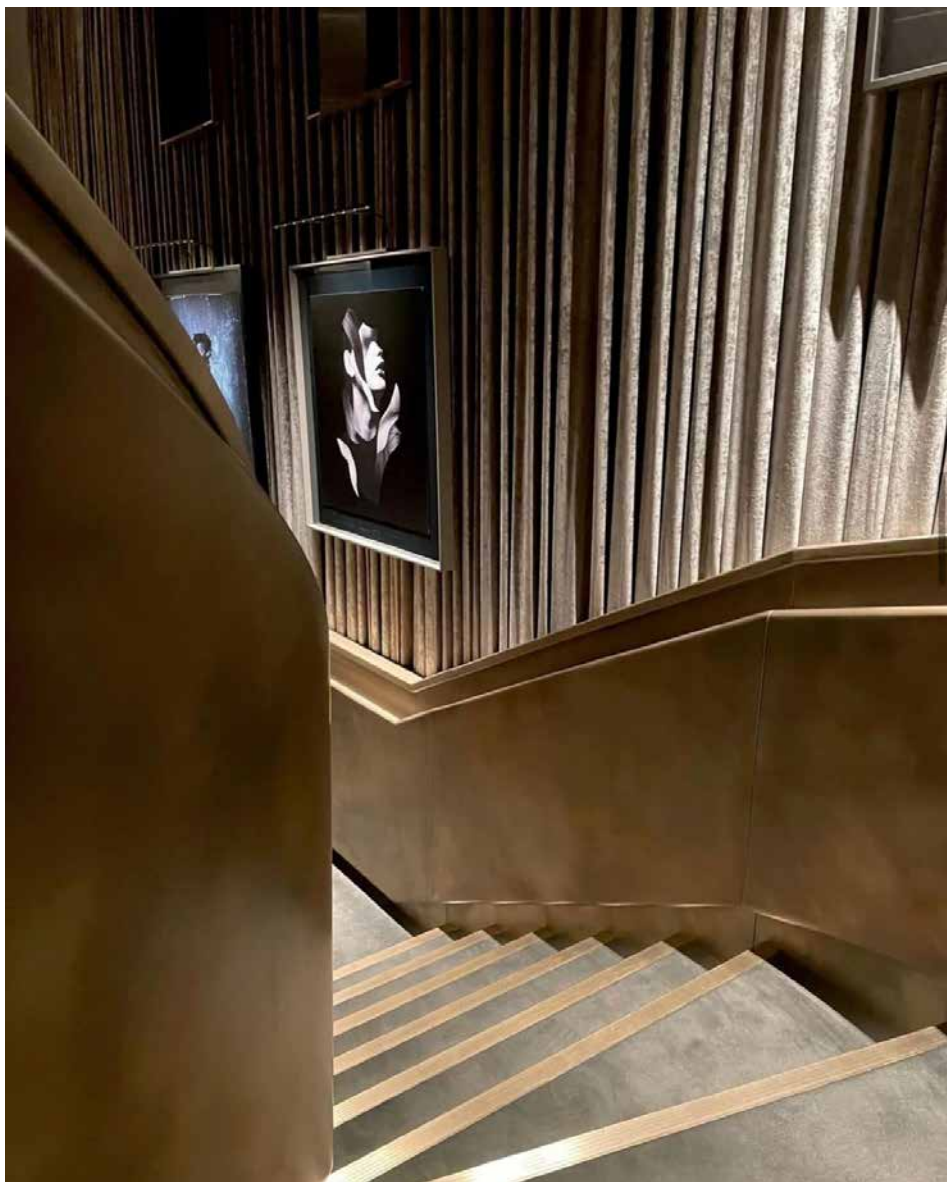



Stair Nosings - Technical Information & Installation

General

C.A.T. stair nosings are manufactured to the highest specification in brass and aluminium. A selection of nosings have ribbed treads, others have castellated treads and there are those with PVC infills which are available in a range of colours.

BTI49.5, ATI49.5 and ATI37.25 tread inserts are also available to provide for an all-metal installation with concealed fixings

Selection

Choose from nosings in various gauges and shapes to accommodate different step edges and floorings. A number of nosings are designed with a diminished edge for retro installation on hard floorings, including vinyl, terrazzo, wood, etc.

Finishes

Brass: Polished Brass • Satin Brass • Antique Brass • Antique Bronze.

Aluminium: Polished • Satin • Mill, plus DHC finishes on stair edge profiles AN20/3 and AN21/3.

Please note that we are constantly developing new finishes. Please contact the C.A.T. sales office for the latest developments.

Data

Brass alloy to BS 2874 : 1986

Aluminium alloy to BS 1474 : 1987

PVC to BS 6746 : 1990

Measuring Steps

When measuring stair nosings steps should be numbered from top to bottom, indicating floor levels, flights and landings for the cutting and installation plan.

Staircases with open strings should be measured oversize by 50mm for cutting on site.

A measuring/ordering sheet can be found in this catalogue or call the C.A.T. sales office for advice.

Installation

It is highly advisable when installing stair nosings to use screw fixings and a suitable adhesive after ensuring that treads and risers are in good order. C.A.T. recommend the use of STYCCO FLEX from F. Ball & Co Ltd for this purpose.

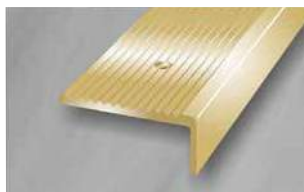

Stair Nosings With Ribbed And Castellated Treads

Can be pre-drilled for screw and adhesive fixing, alternatively nosings can be supplied undrilled for adhesive fixing only if suitable and requested.

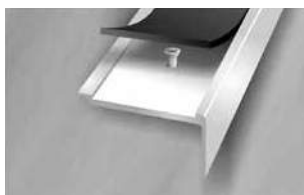

Stair Nosings With PVC Infills & ATI/BTI Infills - Retro Fit

Retro fit option when installing stair nosings with PVC, ATI and BTI infills. Specify retro fit for a neat, concealed fixing finish.

Retro fit nosings are supplied cut to size with pre-drilled channel for countersunk screw fixings. On site, having secured nosings to treads with screws and adhesive, peel away protective cover from adhesive carrier tape, insert infill into channel applying pressure ideally with a roller to ensure a good bond along the entire length of the tread.

Infills should be fitted at normal room temperature, not in cold environments, to avoid the possibility of contraction. Infills supplied oversize for cutting in.



Stair Nosings With PVC Infills With Concealing Plugs

Stair nosings are supplied pre-drilled and affixed with screws and adhesive.

A small 'dab' of adhesive is applied to screw heads and concealing plugs gently tapped level with the infill.



Installation Using Adhesive Only

Whilst C.A.T. recommends that all nosing profiles are fixed with screws and adhesive, it recognises that in some instances an adhesive fixing only is preferred. In these instances we recommend the use of Stycco Flex rapid curing flexible adhesive from F. Ball & Co.

Please contact the sales office for details.

When adhesive only is used, ensure adequate cure time is allowed before allowing pedestrian access to the step(s).



Technical Information & Installation

Profiles To Suit All Step Shapes

Modern stairs the risers tend to be either square or raked back in relation to the treads and without a over hang at the leading edge. By contrast, historical buildings might also feature a bull nose at the leading edge. Whatever the step shape, C.A.T have a range of stair nosings profiles to suit.

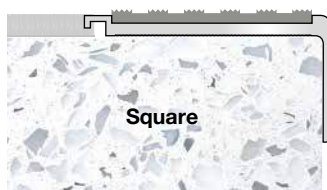

Square



Raked back

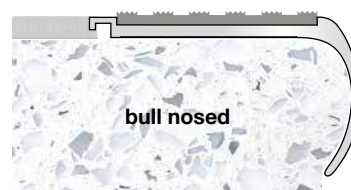

bull nosed

Profiles To Suit All Applications

C.A.T. offer profiles ranging from 0.5mm ramped back to 25mm square back edge thus ensuring a supply to suit all flooring types and thicknesses, as shown in the examples below.

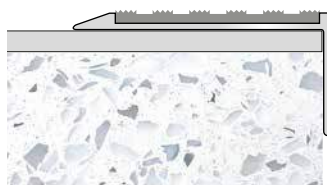

ramped back

to finish the edge of stone and timber stairs and stair fitted with ceramics or hard flooring

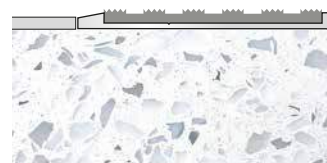

2.5mm gauge

to butt up to LVT, vinyl, lino



5mm gauge

to butt up to carpet and carpet tiles

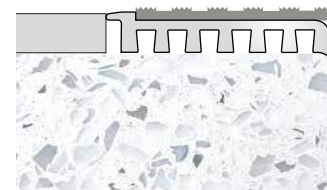

ramped back

to butt up to 10mm or to lip over 8mm floor coverings

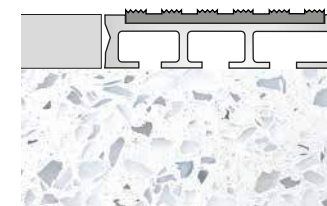

2.5mm gauge

to butt up to thicker floor coverings, ceramics, stone and timber

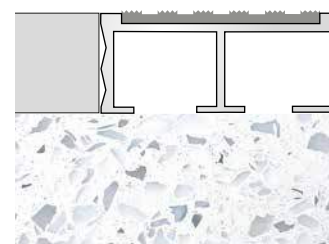

25mm gauge

to butt up to 25mm thick ceramics, stone and timber

Profiles For Modular Assembly

On stairs and landing areas where the stair nosings are required to extend beyond a standard profile tread going, the C.A.T. range of 5mm gauge aluminium profiles include a design feature which allows them to be used in combination, as shown in the example below. If required, profiles can be supplied pre-assemble onto a 1mm gauge aluminium base for single entity on site fixing.

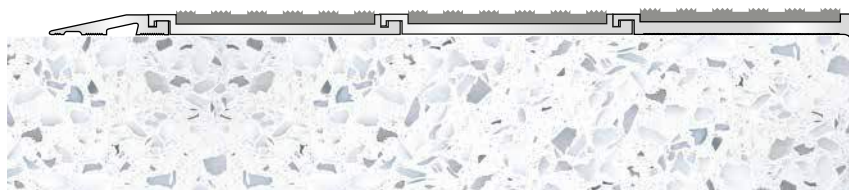

Example shows stair nosing profile AN51, backed by two sections of profile ANEXT tread extender and finished with ramp edge profile ANRE25 combining to provide approximately 210mm overall going cover.



Stair Nosings - Infill, Colour Options & LRVs

Please refer to product page for infill availability.

Light Reflectance Values (LRV)

LRV is a measurement which expresses the percentage of light that is reflected from a surface with lighter finishes at the upper end of the scale and darker finishes at the lower. Designers of buildings need to comply with the building regulations applicable to the structure under consideration. Since 2004 guidance has existed on access to and use of buildings. The guidance is particularly concerned with provisions to assist the disabled, including those who are visually impaired.

The guidance highlights the need for certain surfaces and features to “contrast visually” with their surroundings. This is relevant to a wide range of non-residential buildings including, hospitals, schools, hotels, theatres, etc.



PVC Infills



Castellated

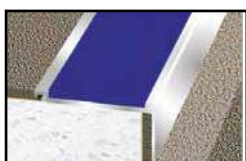

Textured

The current guidance in the regulations and in the relevant codes of practice BS8300:2009 is that adequate visual contrast is provided if the Light Reflectance Value (LRV) of the contrasting areas exceeds 30 points, “i.e., the contrast between the stair edging and the floor covering”. The testing equipment used to assess the LRV of C.A.T. product finishes is an integrated sphere spectrophotometer.

Black
Castellated: LRV 4.25
Textured: LRV 4.47



White
Castellated: LRV 84.22
Textured: LRV 88.85



Light Grey
Castellated: LRV 12.33
Textured: LRV 12.74



Flint
Castellated: LRV 11.27
Textured: LRV 11.66



Granite
Castellated: LRV 7.02
Textured: LRV 7.14



Regency
Castellated: LRV 5.16
Textured: LRV 5.37



Mid Blue
Castellated: LRV 6.53
Textured: LRV 6.71



Nimbus
Castellated: LRV 4.77
Textured: LRV 4.95



Peat
Castellated: LRV 5.88
Textured: LRV 6.04



Rustic
Castellated: LRV 5.52
Textured: LRV 5.79



Fawn
Castellated: LRV 11.27
Textured: LRV 11.53



Ivory
Castellated: LRV 37.42
Textured: LRV 37.65



Spruce
Castellated: LRV 6.38
Textured: LRV 6.59



Jade
Castellated: LRV 7.33
Textured: LRV 7.52



Yellow
Castellated: LRV 54.91
Textured: LRV 55.11



Poppy
Castellated: LRV 10.01
Textured: LRV 10.24



Claret
Castellated: LRV 5.83
Textured: LRV 6.09



Porth Stone
Castellated: LRV 52.91
Textured: LRV 53.11



Polar Grey
Castellated: LRV 42.53
Textured: LRV 42.73



Olympic Carborundum Infill

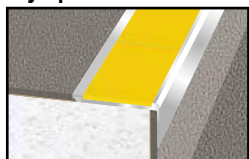

Black
LRV 4.76



Yellow
LRV 47.07



White
LRV 58.45



Olympic Grip Tape

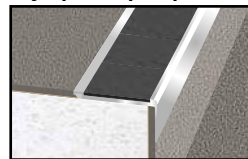

Black
LRV 4.85

Metal Infills



BTI 49.5
LRV's as shown
in table below



Brass

ATI 49.5
LRV's as shown
in table below



Aluminium

LRV's as shown
in table below



Aluminium
Chequer Plate

ATI 49.5
LRV's as shown
in table below



Black Anodised

ATI 37.25
LRV's as shown
in table below



Aluminium

Metal Finishes

Finish	Av.LRV	Finish	Av.LRV	Finish	Av.LRV
Mill Aluminium	71.65	Polished Brass	71.45	Bright Stainless Steel	62.00
Polished Aluminium	75.55	Satin Brass	59.55	Brushed Stainless Steel	53.70
Satin Aluminium	65.40	Antique Bronze	9.15		
Black Anodised	4.80	Chrome	63.60		
Antique Brass	29.55	Satin Chrome	44.85		
Matt Brass	60.55				

Colours shown for guidance only. Please request sample for accurate referencing.



Samples Available



Stair Nosings - Infill Types & SRVs

Slip Resistance and C.A.T. Stair Nosings

C.A.T. stair nosing infills and treads have been independently tested for slip resistance values (SRV).

For use in dry conditions, all our stair nosings and infill test results show a low risk of slip, contributing to the overall safety aspect of interior staircase installations.

We also manufacture a range of purpose designed stair nosings for use in external or wet area, which also show low risk of slip in wet conditions.

The values published are for the normal direction of travel when installed on stairs, i.e., ascending and descending.

It must be noted that many factors will contribute to safety of stairs, not solely the floor covering or the stair nosing fitted. Type of footwear worn, poor maintenance, obstructions, surface contaminants, hurrying, distraction and the influence of alcohol and drugs all have a significant impact on stair safety.

End users and facilities managers should consider regular inspection of stair installations and to act to minimise the risks within their control.

Please contact our sales office for more information and advice.

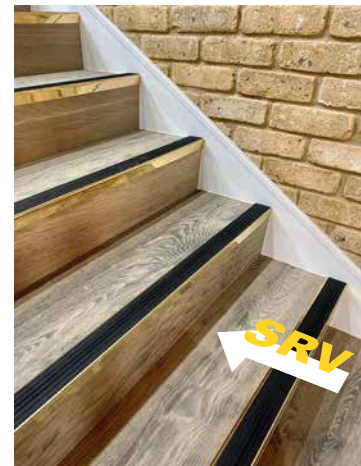

Normal direction of travel - ascending and descending

Test Method

The independent test method used is the Pendulum 4S in conjunction with the guidelines recommended by the UK Slip Resistance Group. UK Slip Resistance Group classified the degree of slip resistance as shown in the table opposite:

Classification	*PTV
High Slip Potential	0 - 24
Moderate Slip Potential	25 - 35
Low Slip Potential	36 +

*Pendulum Test Value

Castellated PVC Infill - Standard Supply



SRV	PTV Dry 85	PTV Wet 76
-----	------------	------------

Smooth Textured PVC Infill



SRV	PTV Dry 65	PTV Wet 56
-----	------------	------------

ATI 49.5 & BTI 49.5 Tread Inserts



SRV	PTV Dry 82	PTV Wet 54
-----	------------	------------

Olympic Carborundum

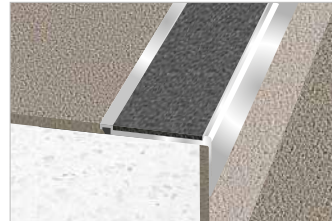

SRV	PTV Dry 92	PTV Wet 86
-----	------------	------------

Ribbed Treads - Brass & Aluminium

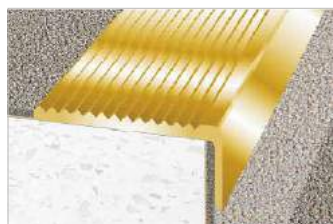

SRV	PTV Dry 73	PTV Wet 45
-----	------------	------------

Castellated Treads - Aluminium



SRV	PTV Dry 82	PTV Wet 54
-----	------------	------------

Colours and finishes shown for guidance only. Please request sample for accurate referencing.



Samples Available



Fabrication & Special Services

Modification Of Standard Profiles

From our extensive range of stair nosings it is often possible to modify an existing standard section to better suit the customers ideal profile.

This modification of a profile can be a cost effective and speedier alternative to the production of a specialist extrusion die and minimum quantity order levels.

The modification of a stair nosing profile means machining off a portion of the standard section to dimensions supplied by the customer.

Typical examples of modifications to a standard extrusion (profile shown is AN6):

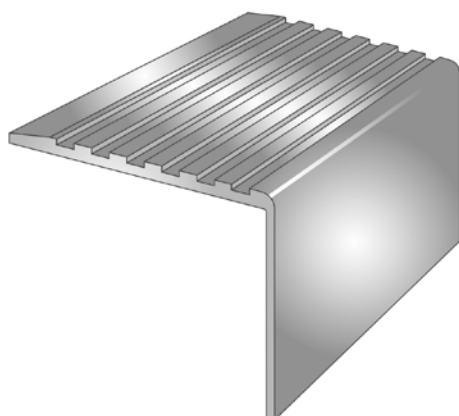

standard profile



riser reduced

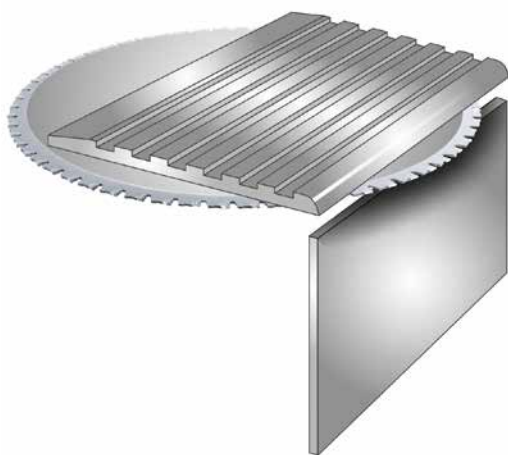

riser removed

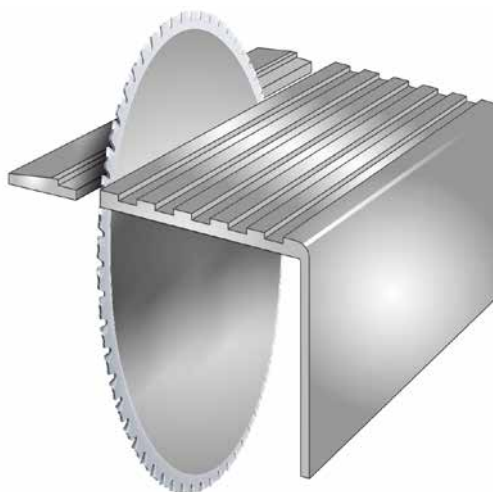

tread reduced

All modifications to the profile are made to customer agreed dimensional drawings. Upon enquiry, C.A.T. will produce a 'Proposal For Supply' drawing to illustrate what is understood to be the customer's requirement. Once confirmed as correct by receipt of an official order, the illustration is issued to our fabrication department for the manufacturing process to begin.

Whatever the fabrication or modification, please check with the C.A.T. sales department or technical representative to determine that the chosen profile is suitable for the purpose.



Special Finishes On Stair Nosings

Examples



Antique Bronze



Antique Brass

A selection of C.A.T. stair nosing products are available with special finishes.

For information on the availability of these or any a finish on a particular product please refer the relevant product page in this catalogue. Should you require further assistance, please contact the C.A.T. sales office.

Finishes depicted are representative only and are subject to print interpretation. For accurate referencing, please request a sample from the C.A.T. sales office.

Brass Finishes - Stair Nosings & BTI49.5 Insert

Antique Brass and Antique Bronze finishes are a chemically applied process to Brass products and are hand finished with a variance from batch to batch. Antique finishes are not foot traffic resistant and are designed to create an aged, unpolished effect.



Mill Brass

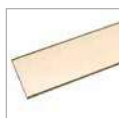

Polished Brass



Satin Brass



Antique Brass



Antique Bronze

Aluminium Finishes - Stair Nosings & ATI49.5 Insert



Mill



Polished



Satin



Black Anodised

DESIGNER HOME COLLECTION

finishes available on AN20/3 and AN21/5.5.



Light Bronze



Bronze



Bright



Onyx



Brushed Stainless



Pewter



Designer Satin

Stainless Steel Finishes



Bright



Brushed



Samples Available

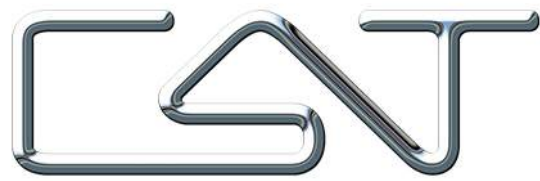

Aluminium Stair Nosings Quick Reference Guides

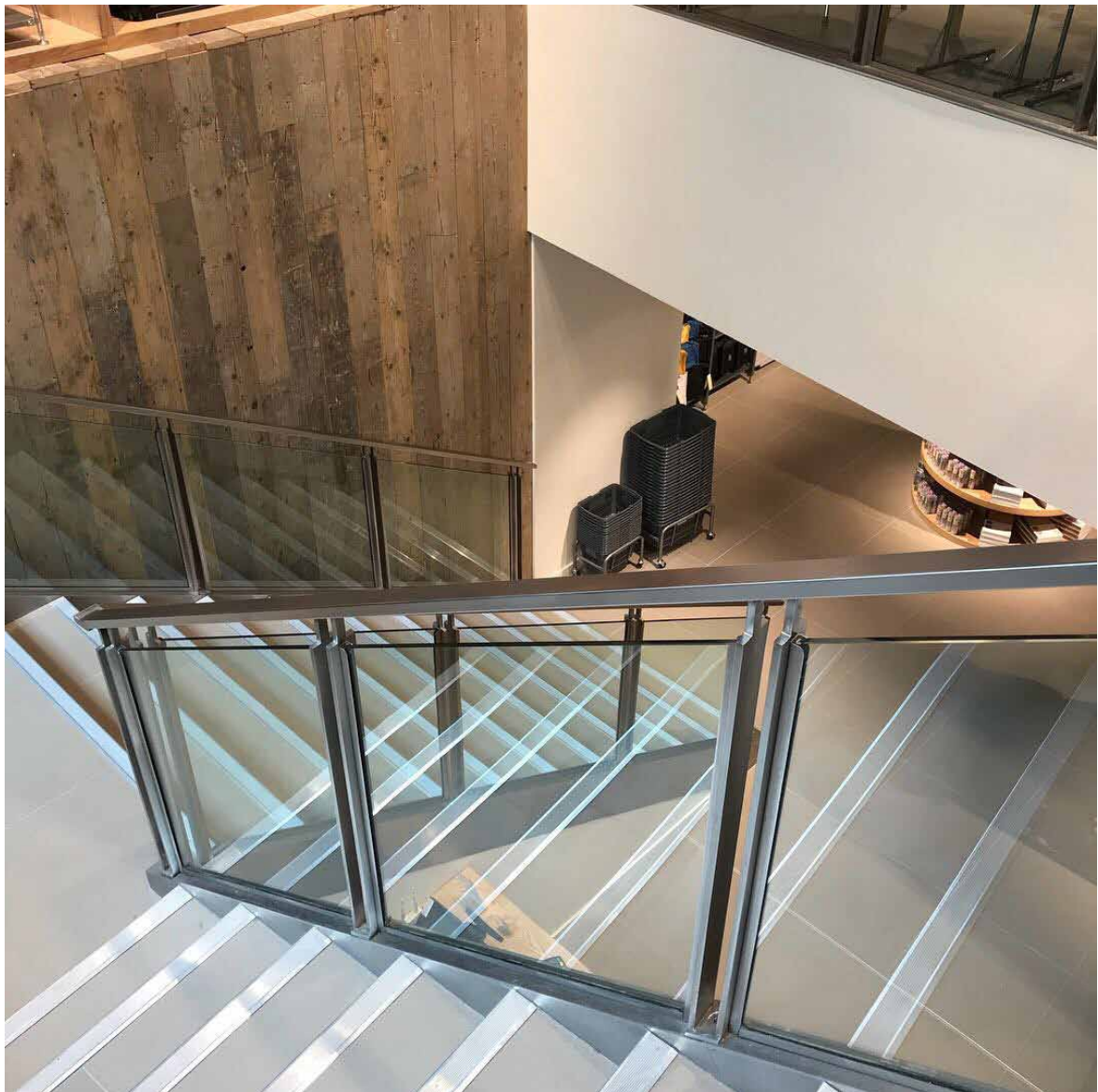



Quick Reference Guide Aluminium LVT Stair Edge Profiles

Commonly used with popular LVT ranges such as Amtico or Karndean within a domestic installation.

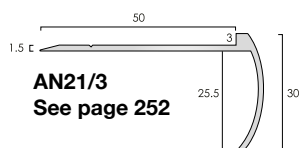
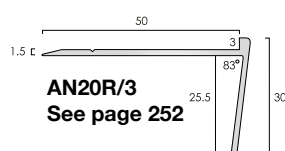
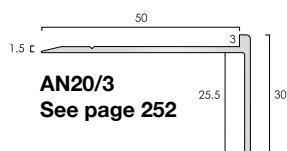

Finishes Available:

AN20/3, AN20R/3, AN21/3:	LRV:
Brushed Stainless	41.45
Bright	81.95
Light Bronze	27.25
Bronze	10.10
Pewter	10.75
Onyx	5.20
Designer Satin	65.30
Mill	71.65

AN20/5.5, AN20R/5.5, AN21/5.5:	LRV:
Mill	71.65
Satin	65.40
Polished	75.55



Profiles shown approximately 1:2 scale. Finishes shown for representation only.

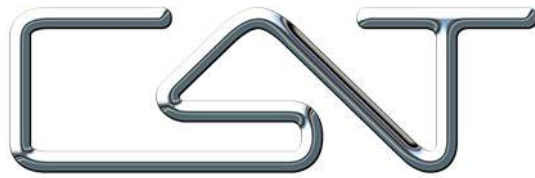

Aluminium Stair Nosings

With Inserts 5mm Gauge



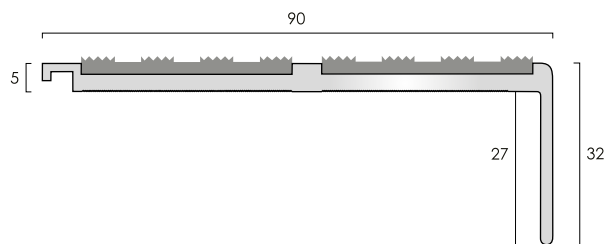

AN52

AN52 aluminium stair nosing is available with a range of infill options, please see below

Typical Installation: To butt up to flooring, or installed with ANE aluminium nap lock profile for carpet installations and ANRE25 aluminium ramp profile to finish the nose edge of stone and timber stairs and stairs fitted with ceramics or hard flooring.

Stringer trims also available to suit.

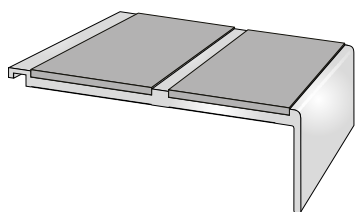
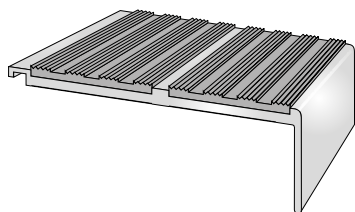

Product Code: **AN52 PVC Castellated** ● ● ● ●
Supplied with a castellated pvc infill available in a range of colours

Finishes Available	Maximum Length	Screw Size
Mill Aluminium	3.200m	8
Satin Aluminium TSO	3.200m	8
Polished Aluminium TSO	3.200m	8

Product Code: **AN52 PVC Smooth Textured** ● ● ● ●
Supplied with a smooth textured pvc infill available in four colour options

Finishes Available	Maximum Length	Screw Size
Mill Aluminium	3.200m	8
Satin Aluminium TSO	3.200m	8
Polished Aluminium TSO	3.200m	8

Castellated PVC Infill Colours:

Black	
Granite	
Peat	
Spruce	
Claret	
White	
Regency	
Rustic	
Jade	
Porth Stone	
Light Grey	
Mid Blue	
Fawn	
Yellow	
Polar Grey	
Flint	
Nimbus	
Ivory	
Poppy	

AT137.25 Finishes

Mill	
Satin	
Polished	
Black Anodised	

Smooth Textured PVC Infill Colours:

Black	
Light Grey	
Polar Grey	
Porth Stone	

other colours available subject to quantity

Olympic Grip Infill Colour:

Black	
-------	--

This profile is also available with Olympic heavy duty carborundum infill to special order. See page 267.

Finishes:



Mill Aluminium



Satin Aluminium



Polished Aluminium

Drilling Availability:

- Drilled retro fit infill
- Drilled for countersunk screws
- Drilled for concealing plugs
- Undrilled

Fixings not supplied

Drilling is available +5% charge.



*To Special Order



Samples Available



Aluminium LVT Stair Edge Profiles





Aluminium Stair Edge Profiles

Designer Finishes For Designer Floors.

Typical Installation: To finish the nose edge of stairs fitted with LVT (Luxury Vinyl Tiles).

Supplied undrilled.

DESIGNER
HOME COLLECTION

Profile **AN20/3 DHC**

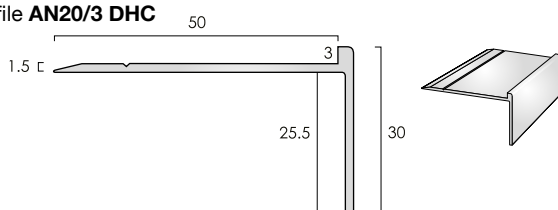

AN20/3 DHC ●

DESIGNER FINISHES FOR DESIGNER FLOORS

Finishes Available	Stock Length
Brushed Stainless	2.750m
Bright	2.750m
Bronze	2.750m
Light Bronze	2.750m
Pewter	2.750m
Onyx	2.750m
Designer Satin	2.750m

DESIGNER
HOME COLLECTION

Profile **AN21/3 DHC**

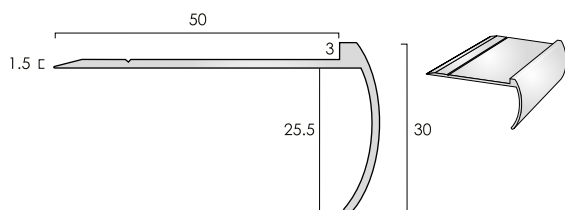

AN21/3 DHC ●

DESIGNER FINISHES FOR DESIGNER FLOORS

Finishes Available	Stock Length
Brushed Stainless	2.750m
Bright	2.750m
Bronze	2.750m
Light Bronze	2.750m
Pewter	2.750m
Onyx	2.750m
Designer Satin	2.750m

DESIGNER
HOME COLLECTION

Profile **AN20R/3 DHC**

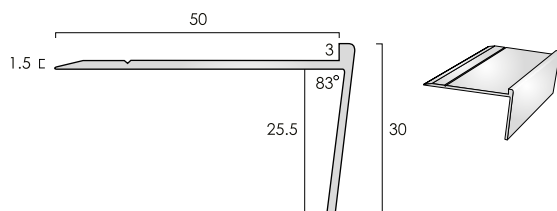

AN20R/3 DHC ●

DESIGNER FINISHES FOR DESIGNER FLOORS

Finishes Available	Stock Length
Brushed Stainless	2.500m
Bright	2.500m
Bronze	2.500m
Light Bronze	2.500m
Pewter	2.500m
Onyx	2.500m
Designer Satin	2.500m

DHC Designer Finishes:



Brushed Stainless
LRV: 41.45

Bright
LRV 81.95

Bronze
LRV 10.10

Light Bronze
LRV 27.25

Pewter
LRV 10.75

Onyx LRV
5.20

Designer Satin
LRV 65.30

Designer Home Collection finishes are anodised finishes and shades can vary from batch to batch.

Drilling Availability:

- Drilled for countersunk screws
- Undrilled

Fixings not supplied

Drilling is available +5% charge.



*To Special Order



Samples Available



Stair Nosing Installation Guides

Product Guide	Page
Stair nosings with PVC infill - for retro fit	356
Aluminium stair nosings with ATI49.5 aluminium insert plate - for hidden fixings	357
FPA Stair tread insert plates	358
Aluminium stair nosings with aluminium concealing trim - for hidden fixings	359
ANE Nap edge profile with stair nosings - for retro fit fixing	360
Brass stair nosings with BTI49.5 brass insert plate - for hidden fixings	361
BNE Nap edge profile with stair nosings - for retro fit fixing	362
BNFE30 Ramp edge profile with stair nosings - for retro fit fixing	363
Stair nosings with ribbed & castellated treads	364
PVC Stair nosings	365



Product Range

General:

ADHESIVE FIX ONLY OF C.A.T. STAIR NOSINGS



C.A.T. are pleased to recommend adhesive fix only on stair nosing installations where F. Ball & Co. Ltd's Stycco Flex Rapid Curing Flexible Adhesive is used.

The benefits of using adhesive only are a speedier installation time and reduced noise during the installation period, ideal for situations where buildings are continually in use or for night time installations.

F. Ball & Co. Ltd have tested Stycco Flex with our aluminium and brass stair nosings and include our products in their Recommended Adhesive Guide.

Stycco Flex adhesive is engineered to secure our extrusions and stair nosings for the life of the installation, subject to the terms and conditions listed below.

Terms & Conditions:

1. The installation must be carried out following the adhesive manufacturer's instructions meticulously.
2. The subfloor to which the stair nosing(s) are to be affixed must be sound, strong and level. The back of the stair nosing must be clean.
3. The type of stair nosing installed must be of the correct specification for the type of application. For guidance, please contact our sales office.
4. The installation must be maintained in accordance with our maintenance guide for the stair nosings.
5. The installation must not be subject to unreasonable force, contamination, abuse or vandalism.
6. For heavily trafficked stairs we still advise the use of mechanical fixings as well as adhesive. See our range of concealed fixing stair nosings for attractive methods of mechanical fixing.
7. Before any claim will be examined, the contractor must supply us with a copy of the invoice for the stair nosings, a copy of the invoice for the adhesive and a copy of the works instructions given by the contractor to the installing fitter.
8. C.A.T. will not accept any claim for bond failure of adhesive fix stair nosings unless all of the above is observed and followed.
9. C.A.T. will not accept any claim for consequential loss.

Access to the stairs should only be permitted when the adhesive has had time to fully cure.



Screws

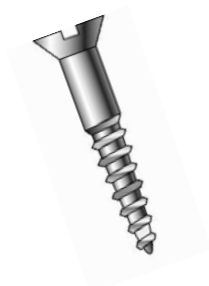

Finishes Available	Size	Box Qty
Zinc Plated	6 x 1.1/4"	200
Zinc Plated	8 x 1.1/4"	200
Brass	6 x 1.1/4"	200
Brass	8 x 1.1/4"	200
Stainless Steel	6 x 1.1/4"	200
Stainless Steel	8 x 1.1/4"	200
Aluminium Anodised	8 x 1.1/4"	200
		50
Chrome	6 x 1.1/4"	200
		50
Chrome	6 x 1.1/2"	200
		50
Chrome	8 x 1.1/4"	200
		50
Antique Brass/Antique Bronze	6 x 1.1/4"	200
		50
Antique Brass/Antique Bronze	8 x 1.1/4"	200
		50



Adhesive

Type	Cartridge Size
Stycco Flex Rapid Curing	290ml



Product Installation Guide

Catalogue Reference: STAIR NOSINGS WITH PVC INFILL FOR RETRO FIT

Product Description: Extruded Brass, extruded Aluminium and formed Stainless Steel profiles supplied with Castellated PVC slip resistant infill for on site retro-fit, concealed fixing.
Profiles supplied cut to customer sizes or in stock lengths for cutting on site, pre-drilled/countersunk for size 8 screws and with double-sided adhesive tape pre-applied into the channel.
PVC infill supplied oversized for trimming on site.

General: It is recommended that stair nosings are installed using *adhesive and screws to ensure against 'rattle' and to achieve the most secure fixing.
PVC Infill should be fitted at room temperature, not cold environments, to avoid the possibility of contraction. If dust, moisture or other contaminants are allowed to come into contact with the exposed adhesive tape, the performance will be seriously affected and may lead to product failure

Installation:

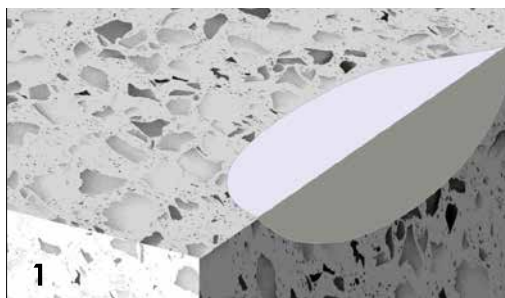

The steps to which the stair nosings are to be affixed must be in good, sound order with any remedial works being completed before commencing the installation.

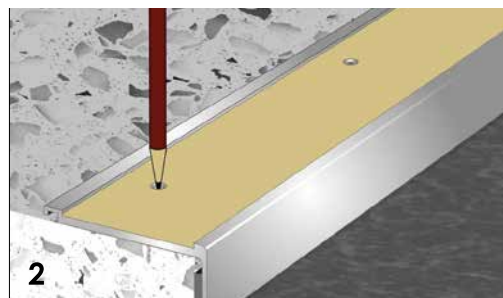

Fit the riser covering (where applicable) before placing the stair nosing profile onto the step to mark off the position of the holes. Drill according to the substrate: pilot holes in timber, holes for plastic plugs in solid surfaces.

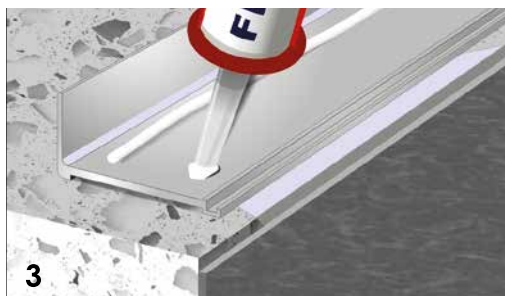

Ensure that the surface of the step is dust and grease free and apply three beads of adhesive to the underside of the stair nosing profile.

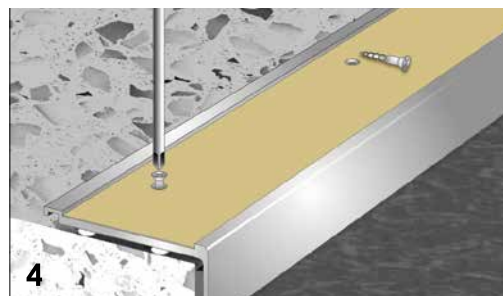

Return the stair nosing profile to the step edge, align with the drilled holes and secure with screws.

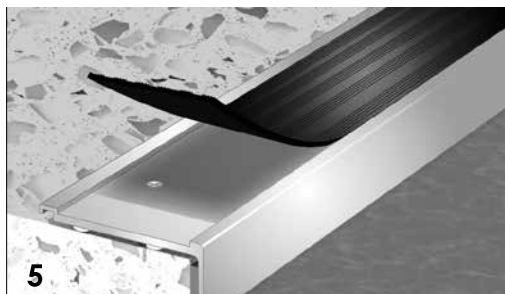

Remove the protective paper to expose the double-sided adhesive tape and starting at one end firmly press the infill into the channel of the profile working along the length. DO NOT STRETCH THE INFILL.

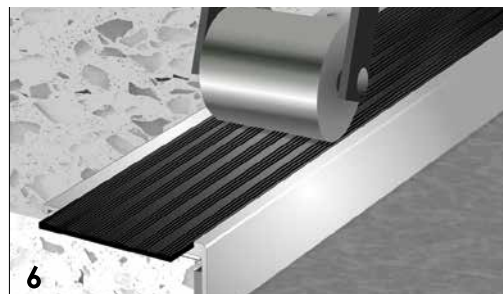

To ensure that the infill is completely bonded, run along the length of the installed piece with a hand roller applying a little pressure to expel any air bubbles. Trim off the excess infill to complete to installation.

Access to the stairs should only be permitted when the adhesive has had time to fully cure.



C.A.T. can now *recommend the use of STYCCO FLEX to fix any of its extensive range of stair nosings, stair edgings and stair insert products. STYCCO FLEX is a rapid curing flexible adhesive with excellent gap filling properties that can be used outside as well as inside.

*subject to following the instructions given by F. Ball and Co Ltd in their STYCCO FLEX product technical data sheet, safety data sheet and installation guidelines, available in full from: www.f-ball.com



Product Installation Guide

Product Range

ALUMINIUM STAIR NOSINGS WITH ATI 49.5 ALUMINIUM INSERT PLATE FOR HIDDEN FIXINGS

Product

Aluminium stair nosing with channel for screw fixings, supplied with separate ATI 49.5 Insert Plate to provide for hidden fixing. ATI 49.5 Insert Plate supplied with self-adhesive tape pre-applied to underside.

Description:

It is recommended that stair nosings are glued and screwed to steps to prevent rattle, provide the most secure fixing and ensure product performance.

General:

Ensure that the steps are level and in good repair. Any remedial work should be completed in advance of fixing the stair nosings and where this requires wet treatments, these must be allowed to fully cure before commencing the installation.

Installation:



The ATI 49.5 Aluminium Insert Plate is supplied loose-laid in the channel of the stair nosing profile. Carefully remove it and set it aside on a flat surface, taking care not to bend or otherwise distort it. Affix the stair nosing profile using size 8 screws and bedding adhesive.

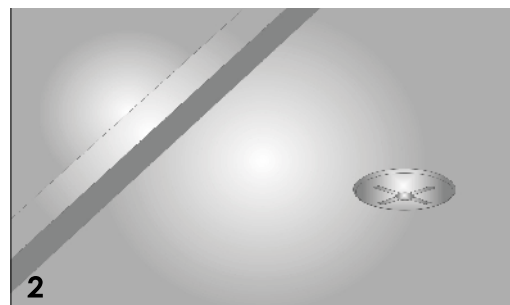

It is vital that all screw heads are down flush or below the surface of the channel. Any that remain raised will compromise the fit and bond of the concealing strip possibly resulting in product failure at a later date.

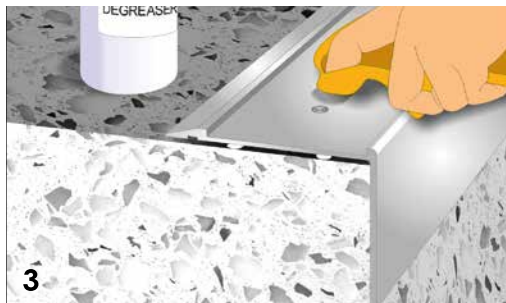

Thoroughly degrease the channel of the now fixed profile and allow all moisture and vapours to fully dissipate.

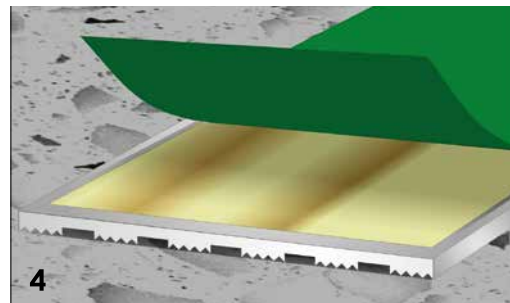

Handling carefully so as not to bend or otherwise distort the ATI49.5 Insert Plate, remove the protective backing paper from the adhesive tape.

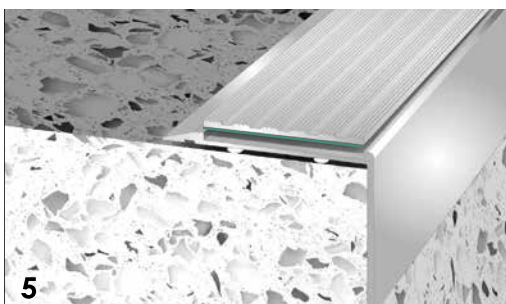

Position the ATI 49.5 Insert Plate over the channel and press into place.

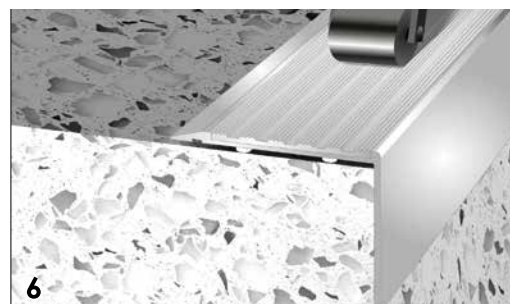

Finish with a seam roller to ensure complete contact along the entire length of the now joined pieces.

Access to the stairs should only be permitted when the adhesive has had time to fully cure.



C.A.T. can now *recommend the use of STYCCO FLEX to fix any of its extensive range of stair nosings, stair edgings and stair insert products. STYCCO FLEX is a rapid curing flexible adhesive with excellent gap filling properties that can be used outside as well as inside.

*subject to following the instructions given by F. Ball and Co Ltd in their STYCCO FLEX product technical data sheet, safety data sheet and installation guidelines, available in full from: www.f-ball.com



Product Installation Guide

Product Range

ALUMINIUM STAIR NOSINGS WITH ALUMINIUM CONCEALING TRIM FOR HIDDEN FIXINGS

Product

Aluminium stair nosing with channel for screw fixings, supplied with separate aluminium concealing trim to provide for hidden fixing. Concealing trim supplied with self-adhesive tape pre-applied to underside.

Description:

It is recommended that stair nosings are glued and screwed to steps to prevent rattle, provide the most secure fixing and ensure product performance.

General:

Ensure that the steps are level and in good repair. Any remedial work should be completed in advance of fixing the stair nosings and where this requires wet treatments, these must be allowed to fully cure before commencing the installation.

Installation:

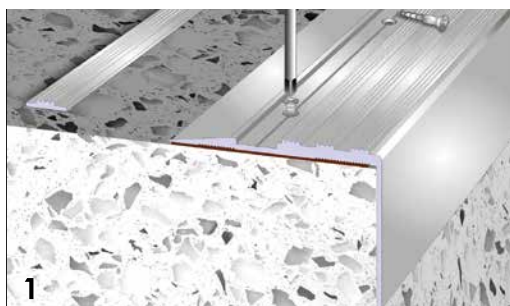

The aluminium concealing strip is supplied loose-laid in the channel of the stair nosing profile. Carefully remove it and set it aside on a flat surface, taking care not to bend or otherwise distort it. Affix the stair nosing profile using size 8 screws and bedding adhesive.

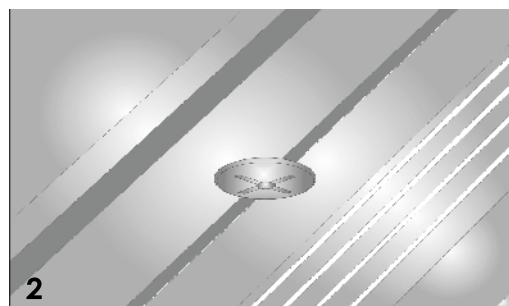

It is vital that all screw heads are down flush or below the surface of the channel. Any that remain raised will compromise the fit and bond of the concealing strip possibly resulting in product failure at a later date.



Thoroughly degrease the channel of the now fixed profile and allow all moisture and vapours to fully dissipate.

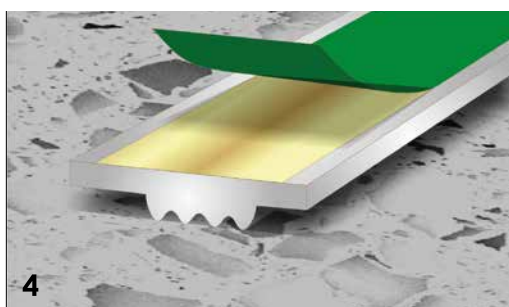

Handling carefully so as not to bend or otherwise distort the concealing strip, remove the protective backing paper from the adhesive tape.

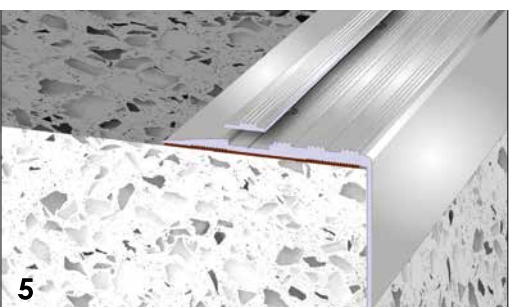

Position the concealing strip over the channel and press into place without bending or distorting it.

Note that the ribs of the concealing strip are not central in the piece and so the strip must be inserted with the widest part of the flat area towards the back edge to ensure symmetry in the finished installation.

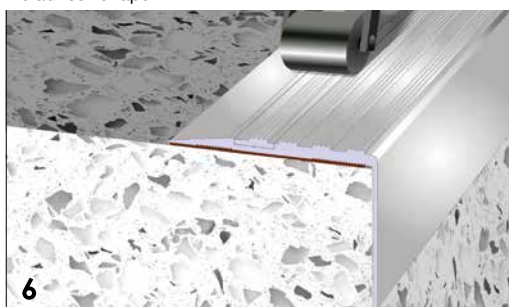

Finish with a seam roller to ensure complete contact along the entire length of the now joined pieces.

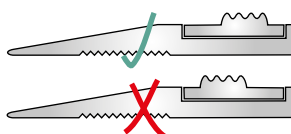

Access to the stairs should only be permitted when the adhesive has had time to fully cure.

C.A.T. can now *recommend the use of STYCCO FLEX to fix any of its extensive range of stair nosings, stair edgings and stair insert products. STYCCO FLEX is a rapid curing flexible adhesive with excellent gap filling properties that can be used outside as well as inside.

*subject to following the instructions given by F. Ball and Co Ltd in their STYCCO FLEX product technical data sheet, safety data sheet and installation guidelines, available in full from: www.f-ball.com





Product Installation Guide

Catalogue Reference:	ANE NAP EDGE PROFILE WITH STAIR NOSINGS USING RETRO-FIT FIXINGS
Product Description:	ANE is an aluminium profile used to trap and protect the nap of the carpet. Designed to interlock with C.A.T. 5mm gauge aluminium stair nosings with interlock feature at the back edge. Supplied pre-punched with carpet gripper and cut to customer sizes or in stock lengths for cutting on site.
General:	It is recommended that nap edges are installed using *adhesive and screws to achieve the most secure fixing.

Installation:

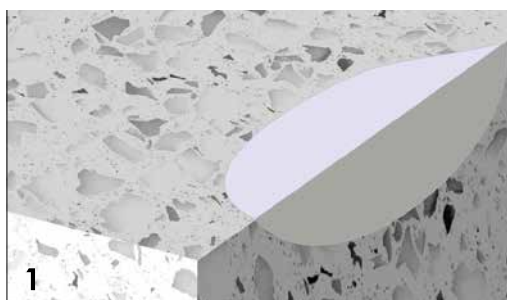

The steps to which the profiles are to be affixed must be in good, sound order with any remedial works being completed before commencing the installation.

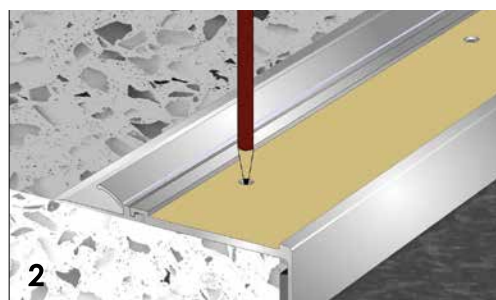

Fit the riser covering (where applicable) before placing the stair nosing profile and the ANE profile onto the step to mark off the position of the holes. Drill according to the substrate: pilot holes in timber, holes for plastic plugs in solid surfaces.

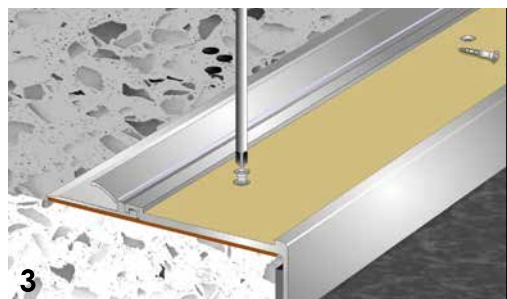

Ensure that the surface of the step is dust and grease free, apply three beads of adhesive to the underside of the stair nosing profile and two beads of adhesive to the underside of the ANE profile. Re-position both profiles over the pre-drilled holes having interlocked the features between the two and secure with screws.



Remove the protective paper from the adhesive tape in the nosing channel, position the PVC infill strip and without stretching it, press it firmly into place before using a seam roller to expel any air bubbles. Trim and fit the tread carpet into the nap edge of the ANE profile.

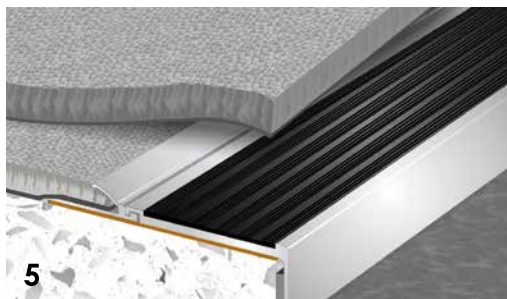

Place a carpet remnant over the nap edge feature to protect it from being scratched.

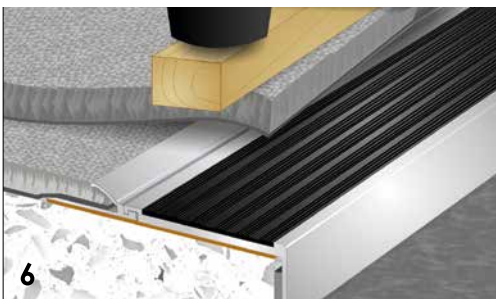

Using a block of wood and a rubber mallet, tap the nap edge down to trap the carpet. Work along the piece with even blows until the required grip has been achieved and the nap edge runs level from end to end.



Access to the stairs should only be permitted when the adhesive has had time to fully cure.

C.A.T. can now *recommend the use of STYCCO FLEX to fix any of its extensive range of stair nosings, stair edgings and stair insert products. STYCCO FLEX is a rapid curing flexible adhesive with excellent gap filling properties that can be used outside as well as inside.

*subject to following the instructions given by F. Ball and Co Ltd in their STYCCO FLEX product technical data sheet, safety data sheet and installation guidelines, available in full from: www.f-ball.com



Product Installation Guide

Product Range

BRASS STAIR NOSINGS WITH BTI 49.5 BRASS TREAD INSERT PLATE FOR HIDDEN FIXINGS

Product Description:

Brass stair nosing with channel for screw fixings, supplied with separate BTI 49.5 Tread Insert Plate to provide for hidden fixing. BTI 49.5 Tread Insert Plate supplied with self-adhesive tape pre-applied to underside.

General:

It is recommended that stair nosings are glued and screwed to steps to prevent rattle, provide the most secure fixing and ensure product performance.

Ensure that the steps are level and in good repair. Any remedial work should be completed in advance of fixing the stair nosings and where this requires wet treatments, these must be allowed to fully cure before commencing the installation.

Installation:

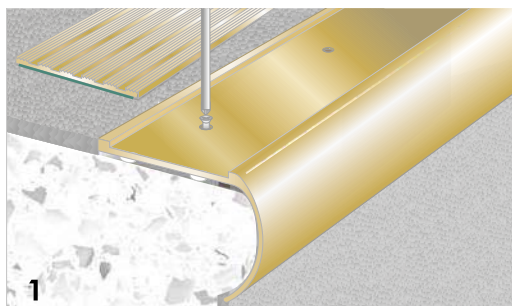

The BTI 49.5 Tread Insert Plate is supplied loose-laid in the channel of the stair nosing profile. Carefully remove it and set it aside on a flat surface, taking care not to bend or otherwise distort it. Affix the stair nosing profile using size 8 screws and bedding adhesive.

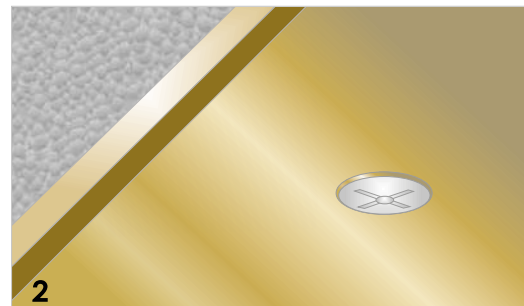

It is vital that all screw heads are down flush or below the surface of the channel.

Any that remain raised will compromise the fit and bond of the BTI 49.5 Tread Insert Plate, possibly resulting in product failure at a later date.



Thoroughly degrease the channel of the now fixed stair nosing profile and allow all moisture and vapours to fully dissipate.

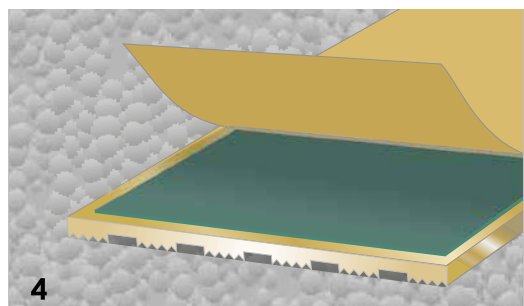

Handling carefully so as not to bend or otherwise distort the BTI 49.5 Tread Insert Plate, remove the protective backing paper from the adhesive tape.

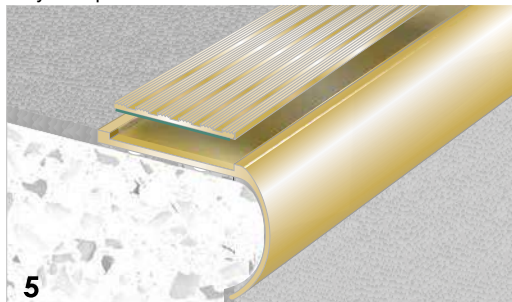

Position the BTI 49.5 Insert Plate over the channel and press into place.

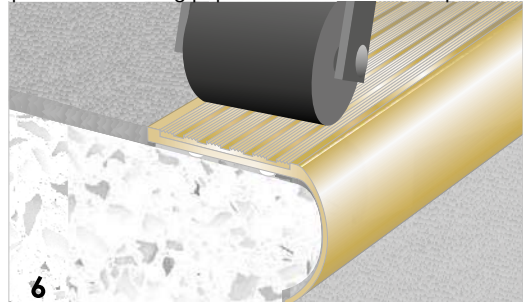

Finish with a seam roller to ensure complete contact along the entire length of the now joined pieces.



Access to the stairs should only be permitted when the adhesive has had time to fully cure.

C.A.T. can now *recommend the use of STYCCO FLEX to fix any of its extensive range of stair nosings, stair edgings and stair insert products. STYCCO FLEX is a rapid curing flexible adhesive with excellent gap filling properties that can be used outside as well as inside.

*subject to following the instructions given by F. Ball and Co Ltd in their STYCCO FLEX product technical data sheet, safety data sheet and installation guidelines, available in full from: www.f-ball.com



Product Installation Guide

Product Range

STAIR NOSINGS WITH RIBBED & CASTELLATED TREADS & RAMPED BACK

Product Description:

Extruded brass profiles with ribbed treads and extruded aluminium profiles with castellated or ribbed treads. Profiles supplied cut to customer sizes or in stock lengths for cutting on site, pre-drilled/countersunk for size 8 screws. The screw heads remain visible in the finished installation.

General:

It is recommended that stair nosings are installed using *adhesive and screws to ensure against 'rattle' and to achieve the most secure fixing.

Installation:

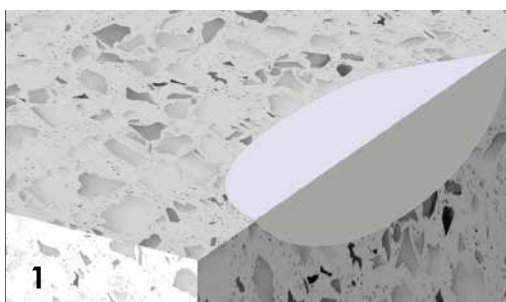

1 The steps to which the stair nosings are to be affixed must be in good, sound order with any remedial works being completed before commencing the installation.

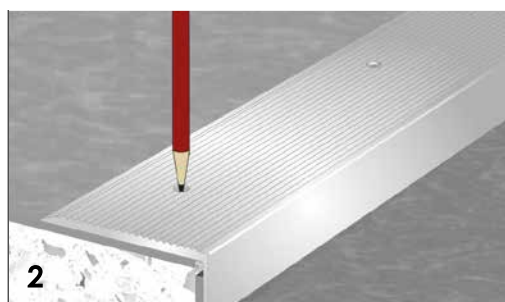

2 When installing a ramp-back profile over a resilient floor covering, fit the covering before placing the stair nosing profile onto the step to mark off the position of the holes. Drill according to the substrate: pilot holes in timber, holes for plastic plugs in solid surfaces.

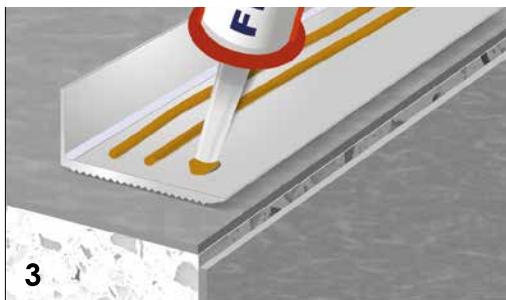

3 Ensure that the surface of the step is dust and grease free and apply three beads of adhesive to the underside of the stair nosing profile.

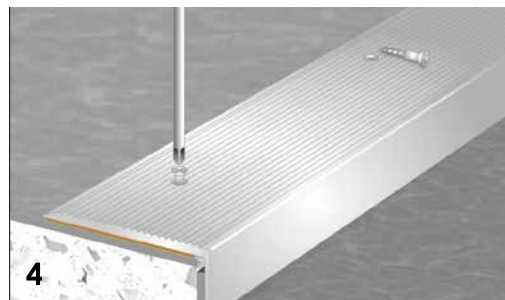

4 Return the stair nosing profile to the step edge, align with the drilled holes and secure with screws.



Access to the stairs should only be permitted when the adhesive has had time to fully cure.

C.A.T. can now *recommend the use of STYCCO FLEX to fix any of its extensive range of stair nosings, stair edgings and stair insert products. STYCCO FLEX is a rapid curing flexible adhesive with excellent gap filling properties that can be used outside as well as inside.

*subject to following the instructions given by F. Ball and Co Ltd in their STYCCO FLEX product technical data sheet, safety data sheet and installation guidelines, available in full from: www.f-ball.com

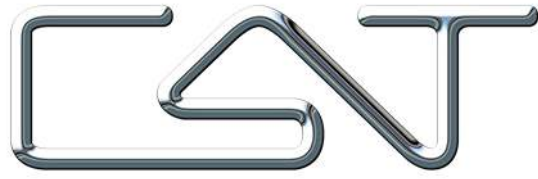

Products Weights



Stair Nosing & Edgings Product Weights

Weights are shown as Kgs/Mtr of standard profile.

Aluminium Stair Edge Profiles

Product	Kgs/Mtr
AN20/3	0.414
AN21/3	0.412
AN20R/3	0.412
AN20/5.5	0.601
AN21/5.5	0.601
AN20R/5.5	0.643

Aluminium Stair Nosings With Ribbed/Castellated Treads

Product	Kgs/Mtr
AN1 SLR	0.606
AN1	0.606
SLR-R	0.459
AN4	0.606
AN5	0.646
AN6	0.646
AN6R AN7	0.898
HDR AN55	0.713
AN55R	0.713

Aluminium Chequer Plate Stair Nosings

Product	Kgs/Mtr
ANCP55/55	0.623
ANCP60/30	0.510
ANCP25/25	0.283

Olympic Aluminium Stair Nosings With Carborundum Infill

Product	Profile Only Kgs/Mtr	with Carborundum Infill Kgs/Mtr
Olympic 35	0.280	n/a
Olympic 70	0.628	0.898
Olympic 78	0.802	1.324
Olympic 150	1.378	2.058
Olympic 551	0.965	1.585
Olympic 552	0.936	1.585
Olympic 761	0.949	1.489
Olympic 761R	0.949	1.489
Olympic AN15/55	0.601	1.024
Olympic AN15/55R	0.601	1.024
Olympic AN51	0.584	1.007
Olympic AN52	0.777	1.419
Olympic AN52R	0.777	1.419
Olympic AN61	0.584	1.007
Olympic AN69	0.823	1.246
Olympic AN81	0.706	1.129
Olympic AN552	0.710	0.964
Olympic ANEXT	0.433	0.856
Olympic ANRE25	0.219	n/a

Aluminium Stair Nosings With Infills

Product	Profile Only Kgs/Mtr	With PVC Infill Kgs/Mtr	With ATI Kgs/Mtr	With Olympic Grip Infill Kgs/Mtr
AN14	0.414	0.604	0.701	0.496
AN15	0.412	0.602	0.699	0.504
AN15R	0.412	0.602	0.699	0.504
AN15/55	0.601	0.791	0.888	0.693
AN15/55R	0.601	0.791	0.888	0.693
AN15/55/13	0.643	0.833	0.930	0.735
AN15/55/13R	0.643	0.833	0.930	0.735
AN50/55	0.709	0.839	0.925	0.777
AN51	0.584	0.774	0.871	0.676
AN51/55	0.704	0.894	0.991	0.796
AN51/55R	0.704	0.894	0.991	0.796
AN52	0.777	1.037	1.209	0.913
AN52R	0.777	1.037	1.209	0.913
AN59 SL	0.390	0.580	0.675	0.489
AN59R SL	0.390	0.580	0.675	0.489
AN59/55SL	0.595	0.785	0.882	0.686
AN59/55RSL	0.595	0.785	0.882	0.686
AN61	0.585	0.775	0.872	0.678
AN65/55 CF	0.981	1.031	1.043	1.004
AN65/55R CF	0.981	1.031	1.043	1.004
AN65/30 CF	0.846	0.896	0.908	0.869
AN65/30R CF	0.846	0.896	0.908	0.869
AN69	0.823	1.013	1.110	0.915
AN70/55 CF	0.835	0.885	0.897	0.858
AN70/55R CF	0.835	0.885	0.897	0.858
AN70/30 CF	0.734	0.784	0.796	0.757
AN70/30R CF	0.734	0.784	0.796	0.757
AN81	0.706	0.896	0.993	0.729
AN82	0.909	1.169	1.341	1.045
AN552	0.710	0.736	n/a	0.725
ANEXT	0.433	0.623	0.720	0.525
ANT60/55	1.142	1.332	1.418	1.234
ANT60/55/12.5	1.088	1.278	1.364	1.180
ANT60/55/14	0.926	1.116	1.202	1.018

Aluminium Stair Nosings With Stainless Steel Covers & Infills

Product	Profile Only Kgs/Mtr	With PVC Infill Kgs/Mtr	With Olympic Grip Infill Kgs/Mtr
SN2SL	0.802	0.992	0.894
SN5	1.136	1.326	1.228
SN6	1.064	1.254	1.156
SN7	1.482	1.672	1.574

Aluminium Nap Lock & Ramp Detail Profiles

Product	Kgs/Mtr
ANE Nap Detail	0.249
ANRE25 Ramp Detail	0.219

Stainless Steel Stair Edge Nosings

Product	Kgs/Mtr
TE30/S	0.684
TEN30/S	0.737



Stair Nosing & Edgings Product Weights

Weights are shown as Kgs/Mtr of standard profile.

Brass Stair Edge Profiles

Product	Kgs/Mtr
BN20	1.040
BN20R	1.040
BN20/15	0.850
BN21	0.990

Brass Stair Nosings With Ribbed Treads

Product	Kgs/Mtr
BN1	2.917
BN1 SLR	1.858
BN1 SLR-R	1.858
BN1 SLR15	1.596
BN1	1.596
SLR15R	2.460
BN2	1.896
BN2 SLR	2.219
BN4	2.469
BN7	1.063
BN9	1.063
BN9R	2.090
BN11	3.458
BN67	3.458
BN67R	3.280
BN90	0.726
BNE	0.710

Brass Nap Lock Detail Profile

Product	Kgs/Mtr
BNE Nap Detail	0.726

PVC Stair Nosings With Castellated Treads

Product	Kgs/Mtr
FPN60	0.256
FPN60R	0.256
FPN60 SLR	0.248
FPN60/55 SLR	0.399

PVC Stair Edge Profiles

Product	Kgs/Mtr
PN20/3	0.145
PN21/3	0.145

Staircase Stringer Trims & Stair Edge Profiles

Product	Kgs/Mtr	Kgs/Welded Angle
AE60	0.795	n/a
AE80	0.975	n/a
AT35	0.392	0.282
AT35/3.5	0.392	0.282
BAT65/15	1.154	n/a
BT35	1.210	0.871
BT50	1.230	0.886
SAT65/15	1.105	n/a
ST40	0.705	0.508

Brass Stair Nosings With Infills

Product	Profile Only Kgs/Mtr	With PVC Infill Kgs/Mtr	With BTI Kgs/Mtr	With Olympic Grip Infill Kgs/Mtr
BN3	1.509	1.699	2.309	1.693
BN5	2.078	2.268	2.878	2.170
BN6	2.078	2.268	2.878	2.170
BN8	2.410	2.600	3.210	2.502
BN14	1.231	1.421	2.031	1.323
BN15	1.201	1.391	2.001	1.293
BN15R	1.201	1.391	2.001	1.293
BN18	1.240	1.410	n/a	n/a
BN52	3.966	4.256	n/a	4.102
BN55	2.866	3.056	3.666	2.958
BN55R	2.866	3.056	3.666	2.958
BN59 SL	1.104	1.294	1.904	1.196
BN59R SL	1.104	1.294	1.904	1.196
BN69	2.431	2.621	3.231	2.523
BN71 SLR	1.773	1.963	2.573	1.865
BN71 SLR-R	1.773	1.963	2.573	1.865
BN71/55 SLR	1.795	1.985	2.595	1.887
BN71/55 SLR-R	1.795	1.985	2.595	1.887

Stair Treads Inserts & Insert Discs

Product	Kgs/Mtr	Product	Kgs/Mtr
AID 25	each 0.007	FPA 10 x 3	0.081
ACP 49.5	0.283	FPA 10 x 6	0.162
ATI 12.5	0.062	FPA 12 x 3	0.097
ATI 37.25	0.216	FPB 6 x 3	0.152
ATI 49.5	0.287	FPB 10 x 3	0.254
ATI 55DC / PVC Infill	0.755	FPB 10 x 6	0.508
ATI 55DC / Olympic Grip	0.675	FPB 12 x 3	0.305
ATI 62 / PVC Infill	0.570	FPB 16 x 3	0.420
ATI 62 / ATI 49.5	0.656	FPB 19 x 3	0.550
ATI 62 / Olympic Grip	0.453	FPSS 10 x 3	0.339
BID 25	each 0.025	FPSS 12 x 5	0.678
BTI 25	0.792	PIP 10	0.084
BTI 49.5	0.800	PIP 12	0.088
BTI 52	1.648	PVC TI 50	0.451
BTI 60 / PVC Infill	1.750		
BTI 60/ BTI 49.5	2.358		
BTI 60 / Olympic Grip	1.650		
Olympic 256	0.320		
Olympic ATI 49.5	0.455		
Olympic ATI 55DC	0.998		
Olympic ATI 62	0.623		
Olympic SS256	0.772		
Olympic SS506	1.394		
Olympic CID 25	each 0.010		
Olympic CID 35	each 0.025		
Olympic CID 50	each 0.035		

Door Threshold Plates

Product	Kgs/Mtr
DTB100/50	2.541
DTBR100/50	2.541
DTS100/50	2.376
DTSR100/50	2.376



Flooring & Wall Profiles Product Weights

Weights are shown as Kgs/Mtr of standard profile.

Where a profile is typically installed in combination with another, e.g. Kliks Tops with Kliks Bases, the weight of each component profile is listed separately.

Feline Profiles

Product	Kgs/Mtr
Feline 1	0.854
Feline 2	0.836
Feline 3	0.964
Feline 4	1.420
Feline A/9/2	0.366
Feline A/10	0.266
Feline A/12Z	0.251
Feline A/13	0.255
Feline A/15	0.311
Feline A25/15	0.242
Feline AT25	0.132
Feline AT35	0.170
Feline T14	0.328
Feline T25	0.443

FAB Profiles

Product	Kgs/Mtr
FAB TT/TL - Brass Top	0.854
FAB TT/TL - S/Steel Top	0.836
FAB TT/SL - Brass Top	0.964
FAB TT/SL - S/Steel Top	1.420
FAB A/12Z - Brass Top	0.366
FAB A/12Z - S/Steel Top	0.266
FAB T28 - Brass Top	0.251
FAB T28 - S/Steel Top	0.255
FAB WIDE TT/SL - Brass Top	0.311
FAB WIDE TT/SL - S/Steel Top	0.242

Feline Base Profiles

Product	Kgs/Mtr
T Base 12 T	0.198
Base 15	0.202

Single Nap Lock Profiles

Product	Kgs/Mtr
ANE	0.232
ANF	0.202
BNE	0.726
BNF	0.506
BNR	0.617
SSNF	0.532

Single Square Edge Profiles

Product	Kgs/Mtr
CAP IT	0.158
Feline Edge	0.766
SS10	0.542
SSE	0.532

Brass Cover Plates

Product	Kgs/Mtr
B155	1.326
B155 SF	1.328
BC28 SF	0.239
BC30	0.305
BC38	0.785
BC38 SF	0.787
BC40	0.406
BC50	0.508
BC55	1.326
BC55	1.328
SF BEP1	1.271
BEP2	1.694

Brass Wide Cover Plates

Product	Kgs/Mtr
BC80	1.355
BC80P	1.538
BC100	1.694
BC100P	1.927

Aluminium Cover Plates

Product	Kgs/Mtr
A155	0.364
A155 SF	0.366
AC38	0.234
AC38 SF	0.236
AC55	0.365
AC55	0.367
SF AEP1	0.392
AEP2	0.540

Aluminium Wide Cover Plates

Product	Kgs/Mtr
AC80	0.600
AC80 SF	0.602
AC82	0.560
AC82 SF	0.562
AC100	0.640
AC110	0.880
AC110 SF	0.890
AC135	1.200
AC135 SF	1.202
BEP2	1.694

Aluminium Chequer Plate Wide Cover Plates

Product	Kgs/Mtr
ACHP80	0.454
ACHP80P	0.637
ACHP100	0.567
ACHP100P	0.750

Aluminium Transition Plates

Product	Kgs/Mtr
T78i / PVC	0.622
T78i / ATI49.5	0.708
T80i / PVC	0.670
T80i / ATI49.5	0.756

Stainless Steel Cover Plates

Product	Kgs/Mtr
S155	0.871
SC28 SF	0.268
SC30	0.285
SC30 SF	0.287
SC38	0.361
SC38 SF	0.363
SC50	0.475
SC50 SF	0.477
SC55	0.871
SC60	0.950
SC60 SF	0.952
SSEP1	1.188
SSEP2	1.584

Stainless Steel Wide Cover Plates

Product	Kgs/Mtr
SC80	1.267
SC80P	1.450
SC100	1.584
SC100P	1.767

Capping Profiles

Product	Kgs/Mtr
CAP IT	0.158
B CAP IT	0.528
B CAP	0.478
S CAP	0.447
SSE	0.532
SSNF	0.532

Aluminium Feather Edge Profiles

Product	Kgs/Mtr
AFE25	0.170
AFE27	0.216
AFE35	0.222
AFE54	0.432
AFE55	0.489
AFE56	0.377
AFE75	0.667



Flooring & Wall Profiles Product Weights

Where a profile is typically installed in combination with another, e.g. Kliks Tops with Kliks Bases, the weight of each component profile is listed separately.

Brass Ramp Profiles

Product	Kgs/Mtr
BLE/2 SF	0.358
BR8 SF	0.636
BR12 SF	0.636
BR15 SF	1.326
BR20	1.326
Kliks Brass Ramp SF	1.136
Kliks Slim Brass Ramp SF	0.782

Aluminium Ramp Profiles

Product	Kgs/Mtr
AR3	0.234
AR3 SF	0.236
AR6	0.234
AR6 SF	0.236
AR8	0.234
AR8/2	0.236
AR8/2 SF	0.238
AR9.5	0.184
AR10	0.234
AR10 SF	0.236
AR12/2	0.365
AR12/2 SF	0.367
AR15	0.365
AR15 SF	0.367
AR63	0.675
AR63/17.5	0.607
AR65	0.955
Kliks Ali Ramp SF	0.381
Kliks Slim Ali Ramp SF	0.252

Aluminium Wide Ramp Profiles

Product	Kgs/Mtr
AR110/10	0.880
ARCP/12	0.397

Aluminium Ramp Profiles With PVC Infill

Product	Kgs/Mtr
T80i R6	0.670
T80i R8	0.670

Stainless Steel Ramp Profiles

Product	Kgs/Mtr
FTRS12	0.618
SLE SF	0.358
SR8 SF	0.477
SR10	0.513
SR12 SF	0.477
SR14	0.599
SR20 SF	0.952

Specialist Ramp Profiles

Product	Kgs/Mtr
ARCP/52/10	0.586
ARCP/70/18	1.167
BR9/50	0.742
BR17/70	1.419
SR9/50	0.709
SR17/70	1.370

Timberline Profiles

Product	Kgs/Mtr
Timberline 1/12A	0.251
Timberline 1/12B	0.630
Timberline 1/12S	0.589
Timberline 1/15A	0.244
Timberline 1/15B	0.656
Timberline 1/15S	0.618
Timberline 1/22A	0.292
Timberline 1/22B	0.762
Timberline 1/22S	0.702
Timberline 2/12A	0.213
Timberline 2/12B	0.530
Timberline 2/12S	0.496
Timberline 2/15A	0.237
Timberline 2/15B	0.561
Timberline 2/15S	0.523
Timberline 2/22A	0.257
Timberline 2/22B	0.642
Timberline 2/22S	0.601

Reflex Movement Joint Profiles

Product	Kgs/Mtr
RAD9	0.388
RAD13	0.452
RAD16	0.500
RAD19	0.548
RAS9	0.209
RAS13	0.241
RAS16	0.265
RAS19	0.289
RBD9	1.004
RBD13	1.142
RBD16	1.242
RBD19	1.344
RBS9	0.517
RBS13	0.586
RBS16	0.636
RBS19	0.687
RSD9	0.822
RSD13	0.870
RSD16	0.932
RSD19	0.980
RSS9	0.426
RSS13	0.450
RSS16	0.481
RSS19	0.505

Perimeter Trim Profiles

Product	Kgs/Mtr
BA ISF	0.637
BA OSF	0.637
BME ISF	0.637
BME OSF	0.637
Kliks End Stop Ali SF	0.284
Kliks End Stop Brass SF	0.682
Kliks End Stop S/S Top SF	0.656
Kliks Slim End Stop Ali SF	0.141
Kliks Slim End Stop Brass SF	0.446
Kliks Slim End Stop Ali With EXP	0.339
Kliks Slim Long End Stop SF	0.176
PTA25/15 ISF	0.189
PTA25/15 OSF	0.189
PTA15/15 ISF	0.135
PTA15/15 OSF	0.135
PTP25/15 ISF	0.133
PTP25/15 OSF	0.133
PTP15/15 ISF	0.099
PTP15/15 OSF	0.099
SA ISF	0.596
SA OSF	0.596
SME ISF	0.596
SME OSF	0.596
Timberline 1/12A SF	0.253
Timberline 1/12B SF	0.632
Timberline 1/12S SF	0.591
Timberline 1/15A SF	0.246
Timberline 1/15B SF	0.658
Timberline 1/15S SF	0.620
Timberline 1/22A SF	0.294
Timberline 1/22B SF	0.764
Timberline 1/22S SF	0.704



Flooring & Wall Profiles Product Weights

Where a profile is typically installed in combination with another, e.g. Kliks Tops with Kliks Bases, the weight of each component profile is listed separately.

Aluminium Angles

Product	Kgs/Mtr
A4.5	0.142
A6.5	0.157
A9	0.179
A13	0.211
A16	0.235
A19	0.259
A22.5	0.286
A25	0.308

Stainless Steel Angles

Product	Kgs/Mtr
S6.5	0.341
S9	0.396
S10	0.404
S12	0.420
S16	0.451
S19	0.475
S22	0.499
S25	0.520

Mainline A Feature Angles

Product	Kgs/Mtr
Mainline A9	0.262
Mainline A11.5	0.284
Mainline A15.5	0.316
Mainline A18.5	0.340
Mainline A21.5	0.364
Mainline A25	0.391
Mainline A27.5	0.413

Aluminium Tag Trim Angles

Product	Kgs/Mtr
TTA4.5	0.060
TTA6.5	0.075
TTA9	0.097
TTA13	0.129
TTA16	0.153
TTA19	0.177
TTA22.5	0.204
TTA25	0.226

Stainless Steel Tag Trim Angles

Product	Kgs/Mtr
TTS6.5	0.255
TTS9	0.270
TTS12	0.287
TTS16	0.311
TTS19	0.328
TTS22	0.345
TTS25	0.363

Mainline A Feature Tag Trim Angles

Product	Kgs/Mtr
Mainline TTA9	0.182
Mainline TTA11.5	0.204
Mainline TTA15.5	0.236
Mainline TTA18.5	0.260
Mainline TTA21.5	0.284
Mainline TTA25	0.311
Mainline TTA27.5	0.333

Brass Angles

Product	Kgs/Mtr
B4.5	0.382
B6.5	0.424
B9	0.487
B13	0.556
B16	0.606
B19	0.657
B22.5	0.717
B25	0.757

Co-ex PVC Angles

Product	Kgs/Mtr
PCE4.5	0.670
PCE6.5	0.740
PCE9	0.870
PCE13	1.080

Co-ex PVC Tag Trim Angles

Product	Kgs/Mtr
TTPCE4.5	0.380
TTPCE6.5	0.460
TTPCE9	0.590
TTPCE13	0.800

Mainline P Feature Angles

Product	Kgs/Mtr
Mainline P8.8	0.195
Mainline P11.3	0.217
Mainline P15.3	0.249
Mainline P18.3	0.273
Mainline P21.3	0.297
Mainline P24.8	0.324
Mainline P27.3	0.346

Brass Tag Trim Angles

Product	Kgs/Mtr
TTB4.5	0.257
TTB6.5	0.299
TTB9	0.362
TTB13	0.431
TTB16	0.481
TTB19	0.532
TTB22.5	0.592
TTB25	0.632

B6 Feature Angles

Product	Kgs/Mtr
B67.5	0.314
B610	0.336
B614	0.368
B617	0.392
B620	0.416
B623.5	0.443
B626	0.465

Mainline P Feature Tag Trim Angles

Product	Kgs/Mtr
Mainline TTP8.8	0.146
Mainline TTP11.3	0.163
Mainline TTP15.3	0.187
Mainline TTP18.3	0.205
Mainline TTP21.3	0.223
Mainline TTP24.8	0.243
Mainline TTP27.3	0.273

Matwell Frames

Product	Kgs/Mtr
BA	0.635
BME	0.635
SA	0.594
SA20/12	0.380
SME	0.594

B6 Feature Tag Trim Angles

Product	Kgs/Mtr
TTB67.5	0.153
TTB610	0.174
TTB614	0.210
TTB617	0.230
TTB620	0.251
TTB623.5	0.274
TTB626	0.301

Brass Feature Angles

Product	Kgs/Mtr
BFA 9/7	0.457
BFA 12/8	0.466
BFA 12/15	0.584
BFA 15/15	0.652

Stainless Steel Feature Angles

Product	Kgs/Mtr
SFA 9/7	0.380
SFA 12/15	0.486
SFA 15/15	0.532
SFA 22/18	0.661



Flooring & Wall Profiles Product Weights

Where a profile is typically installed in combination with another, e.g. Kliks Tops with Kliks Bases, the weight of each component profile is listed separately.

Kliks Tops

Product	Kgs/Mtr
Kliks Twin Top - Brass	0.995
Kliks Twin Top - Aluminium	0.306
Kliks Twin Top - Stainless Steel	0.678
Top Kliks End Stop - Aluminium	0.282
Kliks End Stop - Brass	0.680
Kliks End Stop - Stainless Steel	0.654
Top Kliks Ramp - Aluminium	0.379
Kliks Ramp - Brass	1.134
Kliks Large Ramp - Aluminium	0.567

Kliks Slim Tops

Product	Kgs/Mtr
Kliks Slim Twin Top - Brass	0.609
Kliks Slim Twin Top - Aluminium	0.187
Kliks Slim Twin Top - Stainless Steel Top	0.440
Kliks Slim End Stop - Aluminium	0.139
Kliks Slim End Stop - Aluminium with EXP	0.339
Kliks Slim End Stop - Ali without EXP	0.182
Kliks Slim End Stop - Brass	0.444
Kliks Slim Long End Stop - Aluminium Kliks	0.174
Slim Ramp - Aluminium	0.250
Kliks Slim Ramp - Brass	0.780

Kliks Spectrum Zip Tops

Product	Kgs/Mtr
KSP2	0.200
KSP3	0.200
KSP5	0.250
KSP6	0.333
KSP7	0.217
KSP73	1.217

Kliks Bases

Product	Kgs/Mtr
KB1	0.116
KB2	0.166
KB3	0.200

Kliks Slim Bases

Product	Kgs/Mtr
KKSBA1	0.221
KKSBP9.5	0.102
KKSBP12	0.106
KKSBP15	0.148
KKSBP20	0.186

Kliks Slim Bases

Product	Kgs/Mtr
KAB38	0.204
KAB60	0.283
KB1	0.116
KB2	0.166
KB3	0.200
KB4	0.080

Vertex Corner Protection Profiles

Product	Kgs/Mtr
Vertex 1A SF	0.207
Vertex 1S SF	0.483
Vertex 2A SF	0.288
Vertex 2B SF	1.025
Vertex 2S SF	0.840
Vertex 3A SF	0.413
Vertex 3S SF	1.207
Vertex 41A SF	0.207
Vertex 41B SF	0.732
Vertex 41S SF	0.600

Skirting Profiles

Product	Kgs/Mtr
SK5030/S	0.950
SK5050/S	1.188
SK5050/2S	1.188
SS Scotia 20SF	0.162
SS PWD 20/12	0.832

Stair Rods & Eyes Product Weights

Weights are shown as Kgs/Mtr of standard profile.

Stair Rods

Product	Kgs/Mtr
10mm	1.607
12mm	1.706
16mm	2.014
19mm	2.420
Triangular	1.144

Stair Rod Eyes

Product	Kgs/Mtr
Plain 10mm	0.065
Plain 12mm	0.078
Plain 16mm	0.081
Plain 19mm	0.086
Hinged 10mm	0.061
Hinged 12mm	0.074
Hinged 16mm	0.078
Hinged 19mm	0.082
Top Fixed	0.120



Terms & Conditions

Definitions

Company: Carpet Accessory Trims Ltd. (CAT Ltd) Units 24a,b,&c, Park Avenue Estate, Sundon Park, Luton, LU3 3BP

Customer: Any firm, company or person who purchases products from the Company.

Goods: Any goods or products offered for sale by the Company.

Contract: Any agreement between the Company and the Customer for the supply of goods incorporating these Terms and Conditions.

General

1.1 All quotations are made and all orders are accepted subject to the following conditions. All other terms, conditions or warranties whatsoever are excluded from the contract or any variation thereof unless expressly accepted by the company in writing. Any quotation issued by the company shall not constitute an offer and shall not be binding on the Company.

Each order or acceptance of a quotation for Goods by the Customer to purchase the Goods shall be deemed to be an offer by the Customer to purchase Goods from the Company and is entirely at the discretion of the Company and is subject to these conditions

1.2 If any provision of the Contract is held by a court or other competent authority to be invalid or unenforceable in whole or in part, the validity of the other provisions of the Contract and the remainder of the provision in question shall not be affected.

1.3 Acceptance of delivery of Goods shall constitute acceptance of these conditions where acceptance has not previously been communicated by the Customer to the Company.

1.4 Orders are accepted (save where the contrary is expressed in writing in the acceptance) subject to the availability of stocks of the Goods ordered at the time specified for the delivery.

1.5 The Customer shall not be entitled to rely on any typographical, clerical or other error or omission in any sales literature, quotations, price list, website, acceptance of offer, invoice or other document or information issued by the Company and the Customer acknowledges that any such error or omission shall not form part of or be incorporated by reference into the Contract. Any such error or omission shall be subject to correction without any liability on the part of the Company.

1.6 If any Statement or representation has been made to the Customer by the Company, its servants or agents, upon which the customer relies, other than the documents enclosed with the Company's quotation or acknowledgement of order, then the Customer must set out that statement or representation in a document to be attached to or endorsed on the order and in any such case the Company may confirm, reject or clarify the point and submit a new quotation.

1.6. The company shall not be liable for any loss or damage whatsoever arising from failure by the Company to perform the contract, whether wholly or in part, which is caused by:

(1) Default by our suppliers or

(2) Any cause whatsoever beyond our control.

1.6.3 Our inclusive liability for failure to perform the contract

whether wholly or in part and for negligence (other than for negligence resulting in personal injury or death) shall be limited to:

(1) in cases in which Goods are returned complete and in the condition in which they were dispatched, the supply of replacement goods.

(2) in all other cases the payment of a sum not exceeding the proportion of the net invoice price which is attributable to the goods which are the subject of the claim.

1.6.4 In no circumstances will the Company be liable for indirect or consequential loss or loss of profits.

Delivery

2.1 Time for delivery is given as accurately as possible but is not guaranteed. The Customer shall have no right to damages or to cancel the order for failure for any cause to meet any delivery time stated.

2.2 The date of the delivery shall in every case be dependent upon prompt receipt of all necessary information, final instructions or approvals from the Customer. Alterations by the Customer in design specifications or quantities required may result in delay to the delivery.

2.3 Failure by the Customer to take delivery of or to make payment in respect of any one or more instalments of Goods delivered hereunder shall entitle the company to treat the whole contract as repudiated by the Customer.

2.4 At the discretion of the Company deliveries to site or any address other than the invoice address or the customer's own store may be made upon receipt of the Customers written instructions for which a site delivery surcharge will be made. The Customer must ensure that there is someone available at the delivery site address, aware that the delivery is due and is ready to receive the goods from the delivering vehicle. If delivery cannot be made due to these conditions not being met the Company may impose a reasonable charge for storage and re-delivery.

2.5 The Company will endeavour to comply with reasonable requests by the Customer for postponement of delivery but shall be under no obligation to do so. Where delivery is postponed otherwise than due to default by the Company the Customer shall pay all costs and expenses including a reasonable charge for storage and transportation occasioned thereby and payments for the Goods shall be made in accordance with these conditions.

2.6 Any packaging supplied by the Company unless otherwise expressly agreed is intended to provide adequate protection throughout normal conditions of transit of usual duration.

2.7 The Customer is responsible for unloading the delivery and shall be responsible for loss or of damage to the Goods during the course of such unloading. It is the responsibility of the Customer to inspect the Goods on delivery in respect of design, colour, condition, quantity and quality. The company shall not be obliged to replace Goods once they have been cut and installed.

2.8 The customer must satisfy themselves that those handling the goods wear the correct protective equipment.

2.9 A delivery note or noted document for the Company must be signed on receipt of the Goods.

Risk and Title

3.1 Risk shall pass to the Customer so that the Customer is responsible for all loss, damage or deterioration to the goods.

3.1.1 If the company delivers Goods by its own transport or in accordance with a specific contractual obligation arranges for transport for the Goods at the time when the Goods or relevant part thereof arrive at the place of delivery, or

3.1.2 in all other circumstances at the time when the Goods or a consignment or other part thereof leave the premises of the Company.

3.2 Title to the Goods or any relevant part thereof shall only pass to the Customer upon the happening of any one of the following events:

3.2.1 The Customer has paid the company all sums due and payable by it to the Company under the contract and all other prior contracts between the Company and the Customer, or

3.2.2 when the Company serves on the Customer notice in writing that the title in the Goods or such part thereof has been passed.



Terms & Conditions

3.3 The Company may recover goods in respect of which title has passed to the Customer at any time and the Customer hereby licenses the Company, its offices, employees and agents to enter upon any premises of the Customer for the purposes either of satisfying itself that the condition 3.4 below is being complied with by the Customer or of recovery of any goods in respect of which property has not passed to the Customer.

3.4 Until title to the Goods has passed to the Customer pursuant to the terms hereof it shall possess the goods as a bailee. If the Company so requires the Customer shall store the Goods separately from other Goods and shall ensure they are clearly identifiable as belonging to the Company.

Cancellation

4.1 Cancellation will only be agreed to by the Company on the conditions that all costs and expenses incurred by the Company up to the time of cancellation and all loss of profits and other loss or damage resulting to the Company by reason of such cancellation will be paid forthwith by the Customer to the Company.

Prices

5.1 All prices are, unless otherwise stated, quoted net ex-works exclusive of VAT and are subject to fluctuation in the event of any increase in such cost of labour due to local or national awards or increases in the cost of materials and overheads. Any increase in

such costs during the period of the contract will be added to the quoted price.

5.2 In the event of any alteration being requested by the Customer and agreed by the Company in design or specification the company shall be entitled to make an adjustment of the contract price corresponding to such alteration.

5.3 Prices quoted are for the total quantities shown and the Company may not offer the rates or prices quoted for smaller quantities.

5.4 All deliveries are free other than orders or part orders below the minimum carriage paid order value currently applicable, as specified in a current special quotation or, in the absence thereof, the Company's prevailing price list.

Terms of Payment

6.1 Unless otherwise agreed by the Company in writing the terms of payment shall be net monthly account due and payable on the last day of the month following the month in which the Goods were despatched or would have been despatched save for the postponement otherwise due to default on the part of the Company. The Company shall be entitled to submit its invoice with its delivery advice note or at any time thereafter save that where the delivery has been postponed at the request of or by default of the Customer, then the Company may submit its invoice at any time after the goods are ready for delivery or would have been ready in the ordinary course but for the request or default as aforesaid.

6.2 Where Goods are delivered by instalments the Company may invoice each instalment separately and the Customer shall pay such invoice in accordance with these conditions.

6.3 No disputes arising under the contract nor delays beyond the reasonable control of the Company shall interfere with prompt payment in full by the Customer.

6.4 In the event of default in payment by the Customer the Company shall be entitled without prejudice to any other right or remedy suspend all further deliveries on any contract or contracts between the Company and the Customer without notice and to charge interest on any amount outstanding at the rate of 4% per annum above the Base rate of National Westminster PLC in force at the time when payment was due.

6.5 The Customer acknowledges and by submitting an Order consents to the processing and disclosure by the Company of personal or financial data relating to the Customer relevant to any credit, which may from time to time be afforded by the Company, to credit reference agencies, banks and credit insurers and that such organisations may process the data provided or relevant to any other matter which the Company considers reasonable including, without limitation, any commercial relationship which the Company has with any third party.

Dimensions

7.1 The Company reserves the right to alter or change dimensions of the goods supplied within reasonable limits having regard to the nature of the goods. Dimensions specified by the Company are to be treated as approximate only unless the Customer specifically states in writing that exact measurements are required.

Loss and Damages

8.1 In the event of any loss or damage or delay to any goods delivered at our risk to a Customer or to his agent or otherwise to his order notice of the same shall be given by the Customer forthwith upon delivery (or, in case of the loss of any goods, at the time the Goods should have been delivered) and the Customer shall at the same time take all necessary steps to notify the carrier in writing within 24 hours of such loss, damage or delay and where practicable shall enter a note of the same upon the carrier's receipt. If by reason of the failure by the customer to give any notice as provided above we are preclude from making a recovery from the carrier in respect of the loss or damage or delay complained of then we shall not be liable by the Customer in respect thereof and the Customer shall be liable to pay for the Goods as though no such loss or damage has occurred.

8.2 Orders are accepted subject to the incorporation in the contract of these conditions of sale and any special conditions of sale which shall override and exclude any terms and conditions proposed by the Customer except insofar as acceptance of the same has been communicated by us to the Customer in writing.

8.3 Terms and conditions proposed by a Customer cannot be accepted by our staff without express written sanction. It is a Customers responsibility to ensure that such sanction has been given.

Confidential Information

9.1 All drawings, confidential records, computer software and other information supplied by the Company are supplied on the express understanding that copyright is reserved by the company and the Customer will not without the written consent of the Company either give away, loan, exhibit or sell any such drawings, documents, records, software or other information or extracts here from or copies thereof or use them in any connection with the Goods in respect of which they are issued.

9.2 Prior written permission must be sought before displaying the Company brands or logos on a Customer's website. No other brands or logos shall be used to market, display or sell the Company's products.

Customer's Drawings

10.1 The Customer shall be solely responsible for ensuring that drawings, information, advice and recommendations given to the Company either directly or indirectly by the Customer or by the Customer's agents, servants, consultants or advisers are accurate correct and suitable. Examination or consideration by the Company of such drawings, information, advice or recommendations shall in no way limit the Customer's responsibility thereunder unless the Company specifically agrees in writing to accept responsibility.

10.2 The Customer shall indemnify the Company from and against all actions, claims, costs and proceedings which arise due to the manufacture of goods to the drawings or specifications of the Customer where such drawings or specifications are at fault or where it is alleged that they involve an infringement of a Patent, copyright, registered Design or Design Copyright or other exclusive right.



Terms & Conditions

Data and Technical Information

11.1 The information contained in the advertising, sale and technical literature issued by the company may be relied upon as accurate in the exact circumstance in which it is expressed. Otherwise any illustrations, performance details, examples of installations and methods of assembly and all other technical data in such literature are based on experience and upon trials under test conditions and are provided for general guidance only.

Insolvency

12.1 The risk in all Goods supplied by us shall pass immediately they are delivered into the physical custody of a Customer or his agents or otherwise to his order. We shall retain sole and absolute property in such goods as beneficial owner until such time as all moneys due to the Company from the Customer have been paid in full. Until that time a customer shall be in possession of the Goods as bailee only and shall be deemed to have so acknowledged.

12.2 The Customer's right to possession of any Goods supplied by us shall cease if, being an individual he commits an available act of bankruptcy or, being a company, a receiver becomes entitled to take possession of any of its assets or any person becomes entitled to present a petition for its winding up or it is resolved that it be wound up. Or under any circumstances where the moneys due to the Company are not forthcoming we shall be entitled in these events to enter at any time with or without vehicles upon the premises at which we reasonably believe such Goods to be stored and to repossess them.

12.3 A Customer shall be at liberty in the ordinary course of business to process and make product from and as our agent, to sell the Company's Goods, whether paid for or not. The proceeds of any such sale shall be for our accounts and shall be held in trust for us to the extent of the full price of the goods.

Return of Goods

13.1 Returns of goods supplied as ordered are not normally accepted and will be at the discretion of CAT Ltd.

13.2 The company will not accept the return of any material correctly supplied due to over ordering or incorrect product choice by the customer.

13.3 The return of any goods will be subject to a minimum re-stocking charge of 35% of their invoiced value or £25 whichever sum is the greater.

13.3 In the event that an agreement is reached for goods to be returned the customer will need to arrange for the return of the goods at their own cost.

13.4 Any goods returned must be undamaged and in re-saleable condition before any credit is raised.

13.5 Products that have been installed cannot be returned.

Force Majeure

14.1 Neither party shall be under any liability for any delay, loss or damage caused wholly or in part by act of God, governmental restriction, condition or control or by any reason of an act done or not done pursuant to trade dispute whether such dispute involves its employees or not or by reason of any other act, matter or things beyond its reasonable control including failure by the other party to carry out provision of these conditions.

Legal

15.1 The contract shall be governed and interpreted exclusively according to the Law of England and shall be subject to jurisdiction of the English courts only.



Metric & Imperial Conversions

Easy Conversion Chart

(to 2 significant figures)

Metric	Imperial
0.900m	2' 11"
1.0m	3' 3"
1.83m	6' 0"
2.0m	6' 6"
2.5m	8' 2"
2.715m	8' 11"
2.750m	9' 0"
3.2m	10' 6"

Length

Metric		Imperial	Imperial		Metric
1 mm		0.03937 inches	1 inch		2.54 cm
1 cm	10 mm	0.3937 inches	1 foot	12 inches	0.3048 m
1 m	100 cm	1.0936 yards	1 yard	3 feet	0.9144 m
1 km	1000 m	0.6214 mile	1 mile	1760 yards	1.6093 km

Area

Metric		Imperial	Imperial		Metric
1 cm ²	100 mm ²	0.1550 inches ²	1 inch		6.4516cm ²
1 m ²	10,000 cm ²	1.1960 yards ²	1 foot ²	144 inches ²	0.0929m ²
1 hectare	10,000 m ²	2.4711 acres	1 yard ²	9 feet ²	0.8361m ²
1 km ²	100 hectares	0.3861 miles ²	1 acre	4840 yards ²	4046.9m ²
			1 mile ²	640 acres	2.59km ²

Volume

Metric		Imperial	Imperial		Metric
1 cm ³		0.0610 inches ³	1 inch ³		16.387 cm ³
1 *dm ³	1,000 cm ³	0.0353 feet ³	1 foot ³	1,728 inches ³	0.0283 m ³
1 m ³	1,000 *dm ³	1.3080 yards ³	1 fluid oz		28.413 millilitres
1 ltr	1 *dm ³	1.7598 pints	1 pint	20 fluid ozs	0.56831 ltrs
1 hectolitre	100 ltrs	21.997 gallons	1 gallon	8 pints	4.5461 ltrs

*cubic decimetre

Weight

Metric		Imperial	Imperial		Metric
1 mg		0.0154 grains	1 oz	437.5 grains	28.35g
1 g	1,000 mg	0.0353 ozs	1 lb	16 oz	0.4536 kgs
1 kg	1,000 g	2.2046 lbs	1 stone	14 lb	6.3503 kgs
1 tonne	1,000 kgs	0.9842 long ton	1 cwt	112 lb	50.802 kgs
			1 long ton (UK)	20 cwt	1.016 ton
			1 short ton (US)	17.857 cwt	0.9072 ton

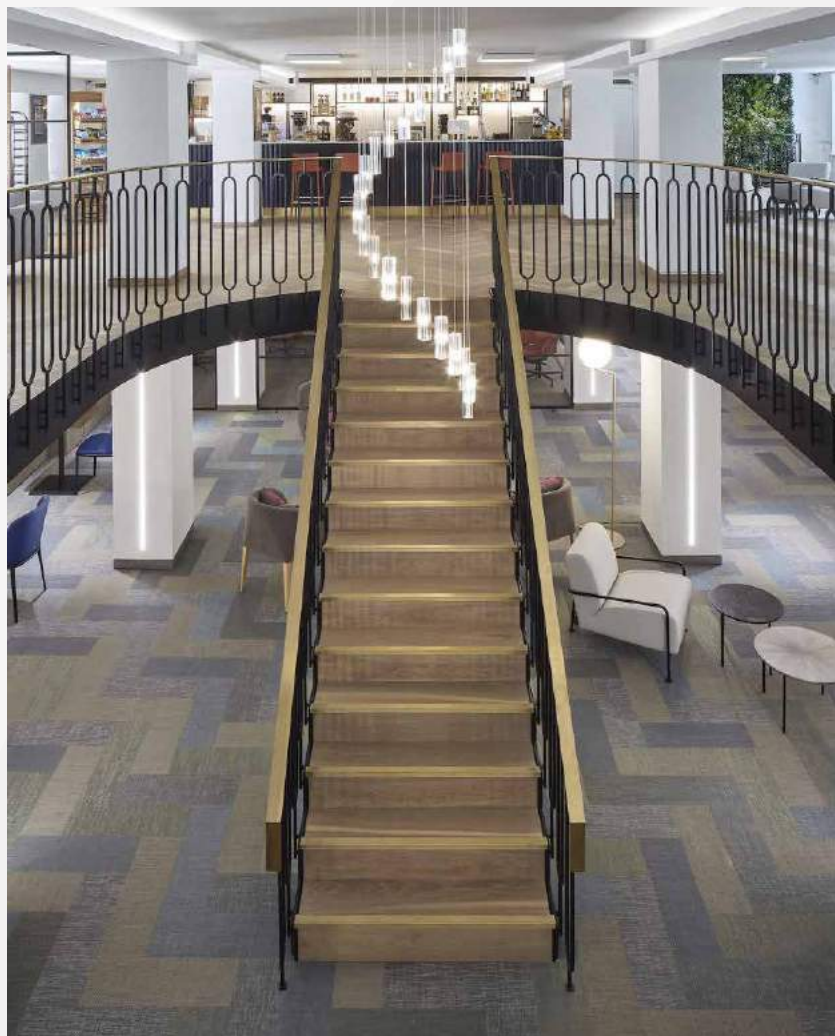

Part of the COBA Group

Carpet Accessory Trims Ltd

Park Avenue Estate, Units 24 A,B,C, Sundon Park Rd,
Luton LU3 3BP, United Kingdom

+44 (0) 1582 561500 sales@cat-accs.com

www.thecatweb.com

